



Wheatley Close, NW4

£325,000

A spacious two double bedroom flat in this sought after development in Hendon. This ground floor flat comes with no chain, has allocated parking, access to communal gardens and has a separate kitchen.

Wheatley Close is situated close to the Laboratory Health Club, Sunny Hill Park and main arterial routes.

Features

- Allocated Parking
- Chain Free
- Two Double Bedrooms
- Ground Floor
- Communal Gardens
- Separate Kitchen

Wheatley Close, London, NW4

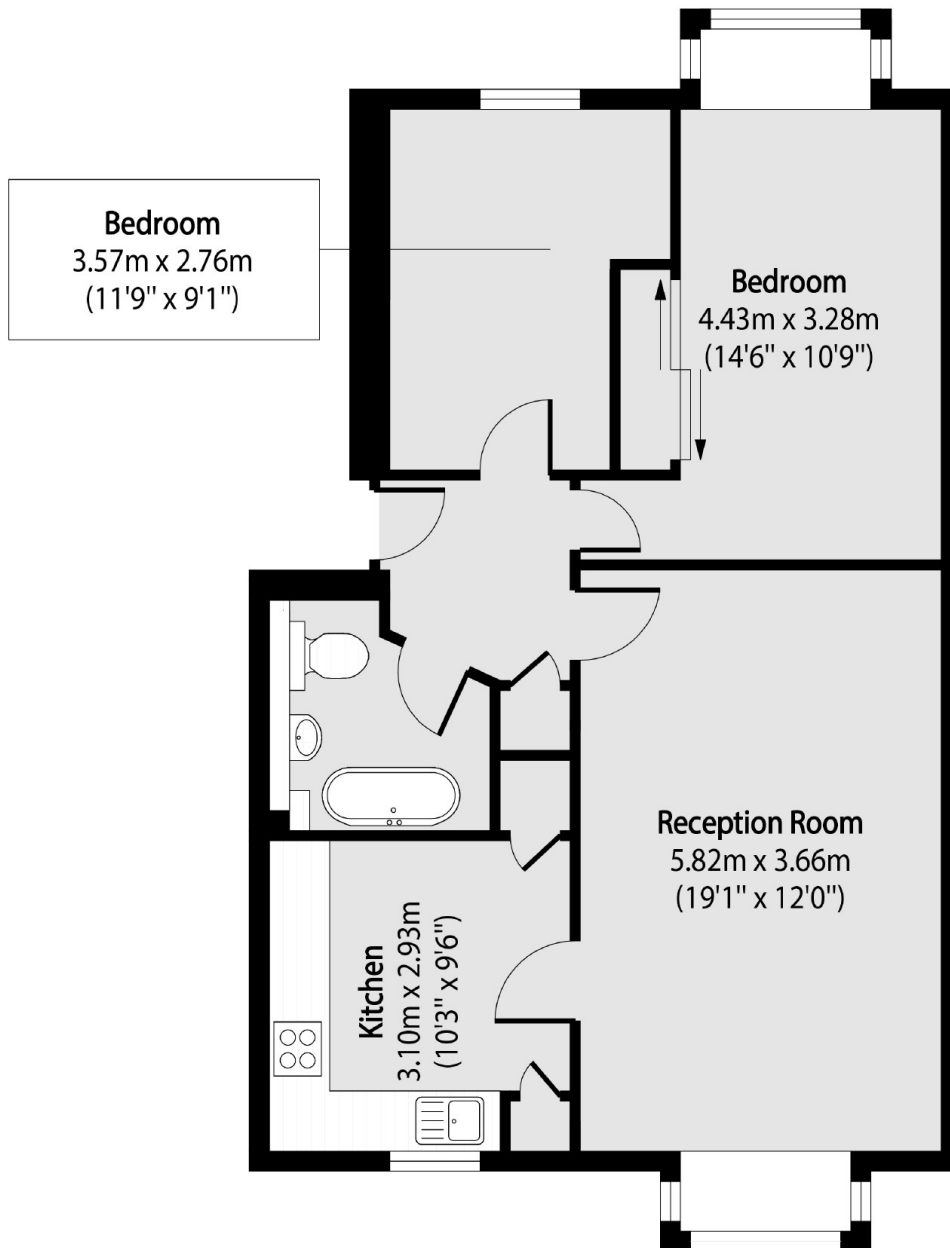

Total area (approx): 63.89 sq m (688 sq. ft)