



## Harvey Close, NW9

### £375,000

A lovely two double apartment located within this well-presented modern Edition development. This excellent home is in great condition throughout, spacious and comes with an allocated parking space.

Harvey Close is a popular road situated moments from Colindale underground station and from the restaurants and cafés on Colindale Avenue.

### Features

- Two Double Bedrooms
- Spacious
- Allocated Parking Space
- Close to underground station
- Great Condition Throughout
- Modern Development

Harvey Close,  
London, NW9

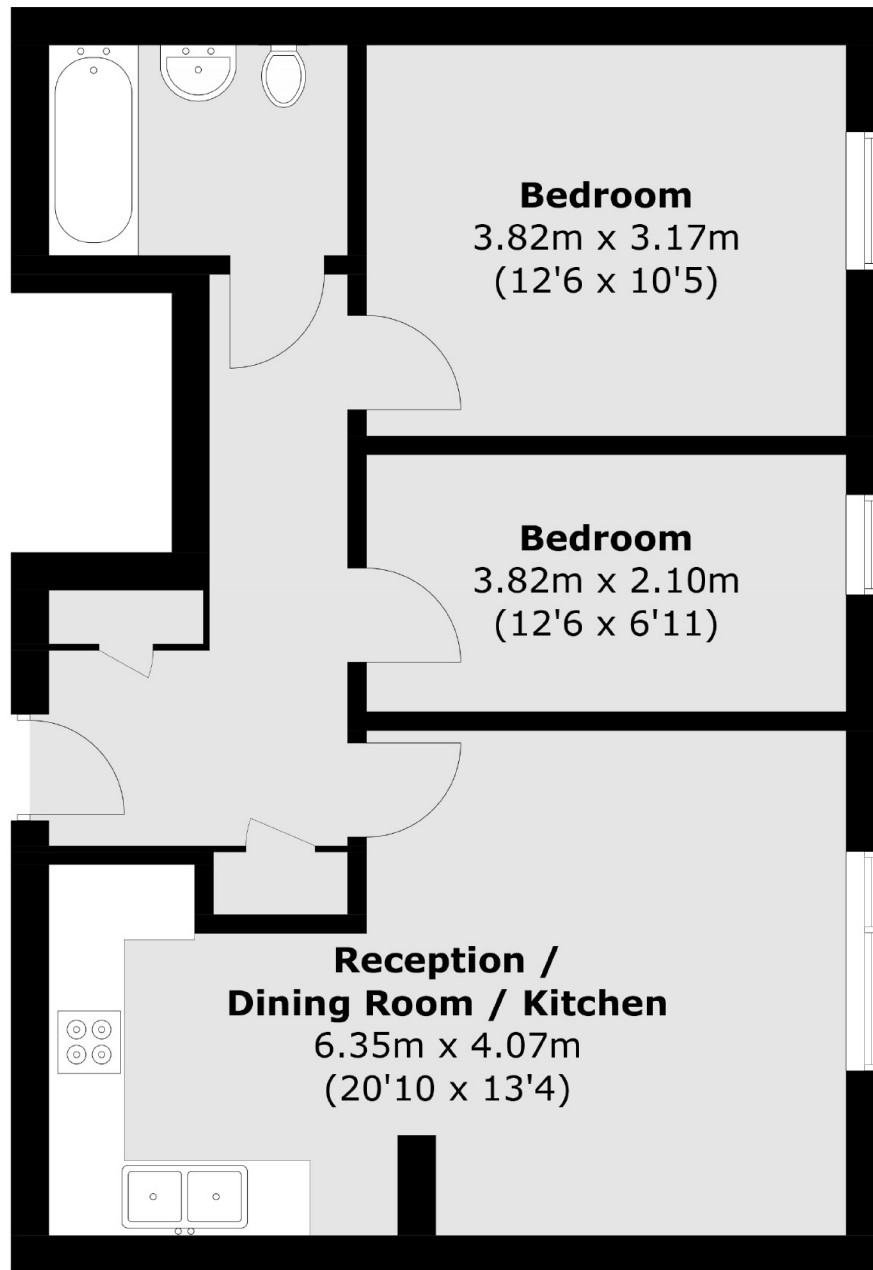

Total area (approx.): 57.0 sq. m ( 613.5 sq. ft)

**Dexters**

Hendon  
18 Central Circus  
London  
NW4 3AS  
Sales  
020 8545 8586

Energy Rating: C. We aim to make our particulars both accurate and reliable. However they are not guaranteed; nor do they form part of an offer or contract. If you require clarification on any points then please contact us, especially if you're traveling some distance to view. Please note that appliances and heating systems have not been tested and therefore no warranties can be given as to their good working order.

 **RICS** | Regulated  
Estate Agent  
and Letting Agent

[dexters.co.uk](https://dexters.co.uk)