



Hillside, NW9

£625,000

A fantastic three bedroom semi-detached family home. This excellent property benefits from off-street parking, two shower rooms, a separate garage and a large, secluded garden.

Hillside is a cul-de-sac ideally located off of Hay Lane. Kingsbury Station (Jubilee line) and Colindale Station (Northern line) are nearby, alongside other shops and amenities.

Features

- Semi-Detached House
- Three Bedrooms
- Two Shower Rooms
- Large Garden
- Off-Street Parking
- Garage

Hillside,
London, NW9

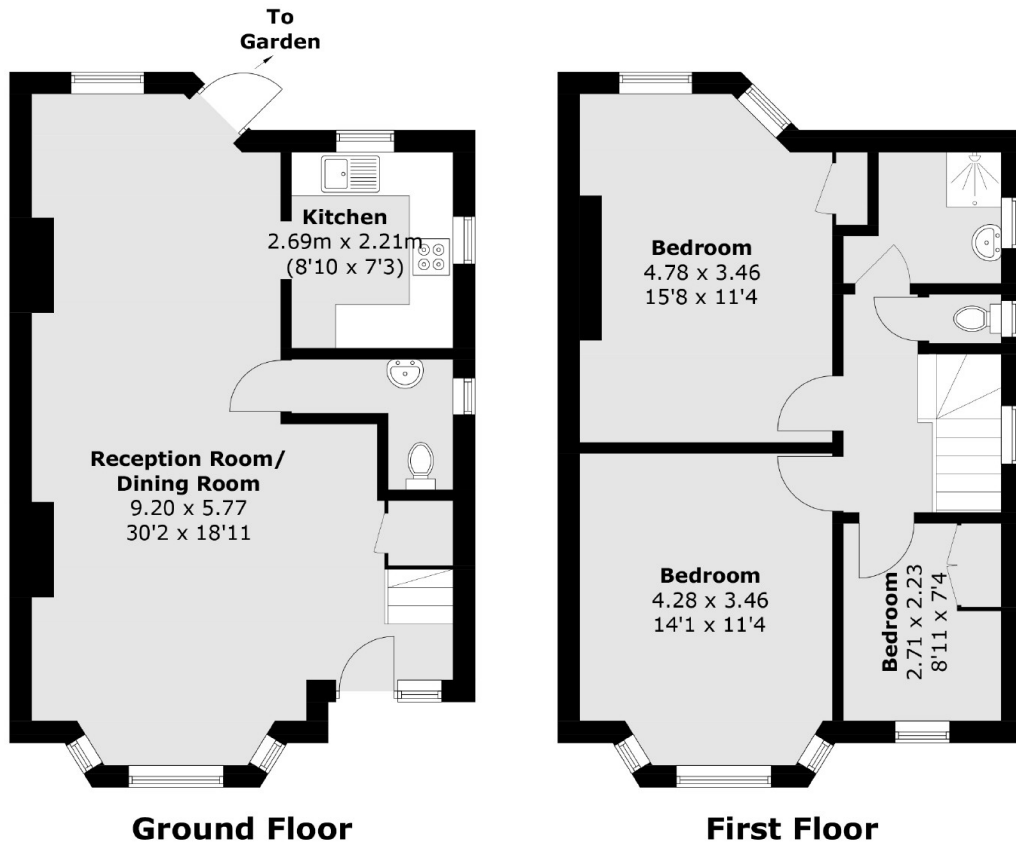

Total area (approx.): 95.9 sq. m (1032.2 sq. ft)