



Mornington Close, NW9

£350,000

An excellent two double bedroom flat located within this modern handsome block. This practical home comes with a private balcony, parking space, a separate kitchen and is offered chain free.

Mornington Close is a popular road situated moments from Colindale Underground Station and from the restaurants and cafés on Colindale Avenue.

Features

- Two Double Bedrooms
- Private Parking
- Private Balcony
- Chain Free
- Modern Flat
- Separate Kitchen

Mornington Close, London, NW9

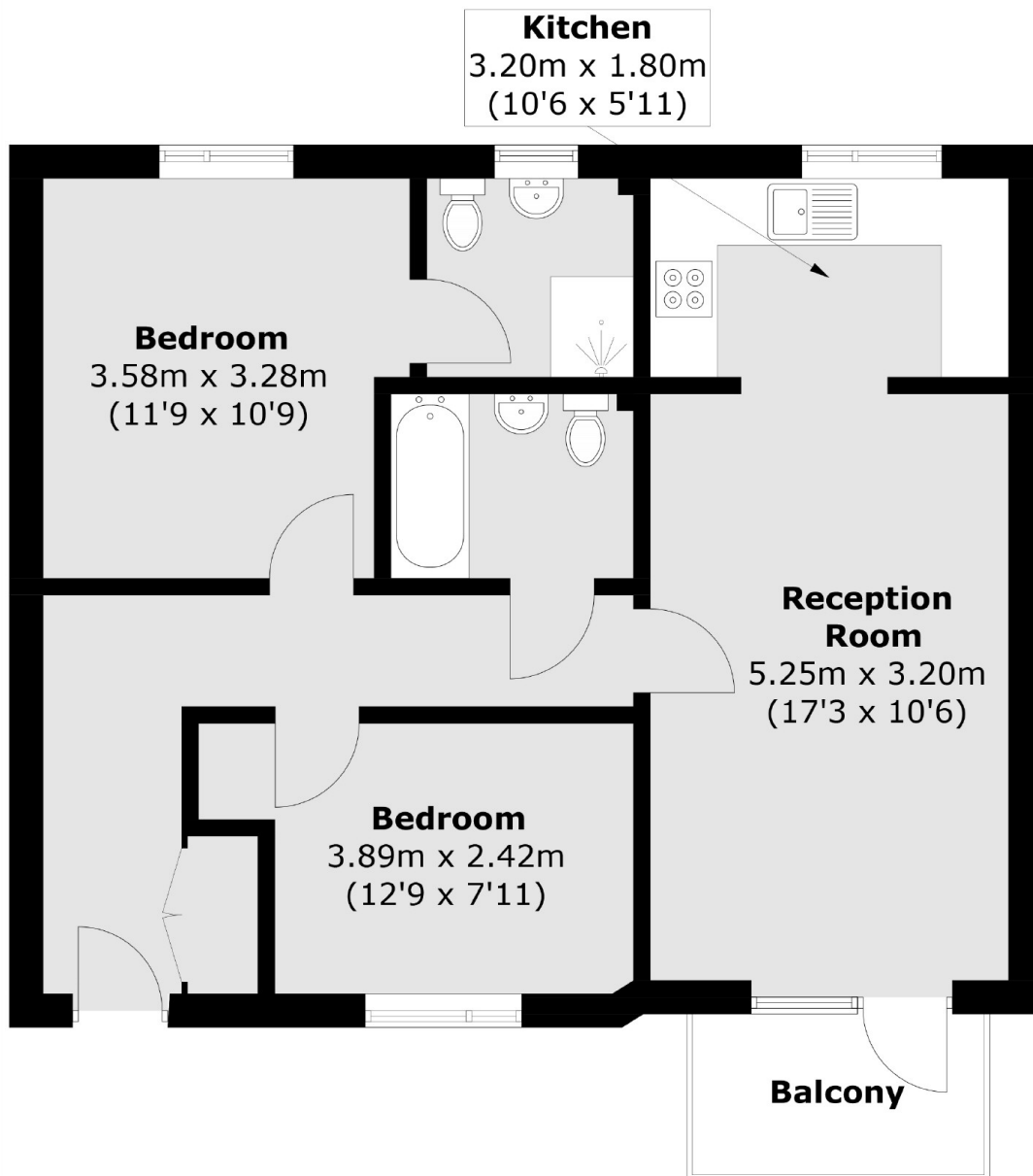

Total area (approx.): 63.0 sq. m (678.1 sq. ft)
Balcony: 3.7 sq. m (39.8 sq. ft)