



## Heritage Avenue, NW9

£375,000

This is a well presented two bedroom two bathroom apartment with a private balcony, access to the communal gardens, Gym and Spa area within the Beaufort Park development.

Pinnacle House is located in the Beaufort Park development with a range of shops and cafe's, Colindale Underground Station with a short distance away.

### Features

- Beaufort Park Development
- Two Bedrooms
- Two Bathrooms
- Private Balcony
- Communal Gardens
- Access to Spa area

# Heritage Avenue, London, NW9

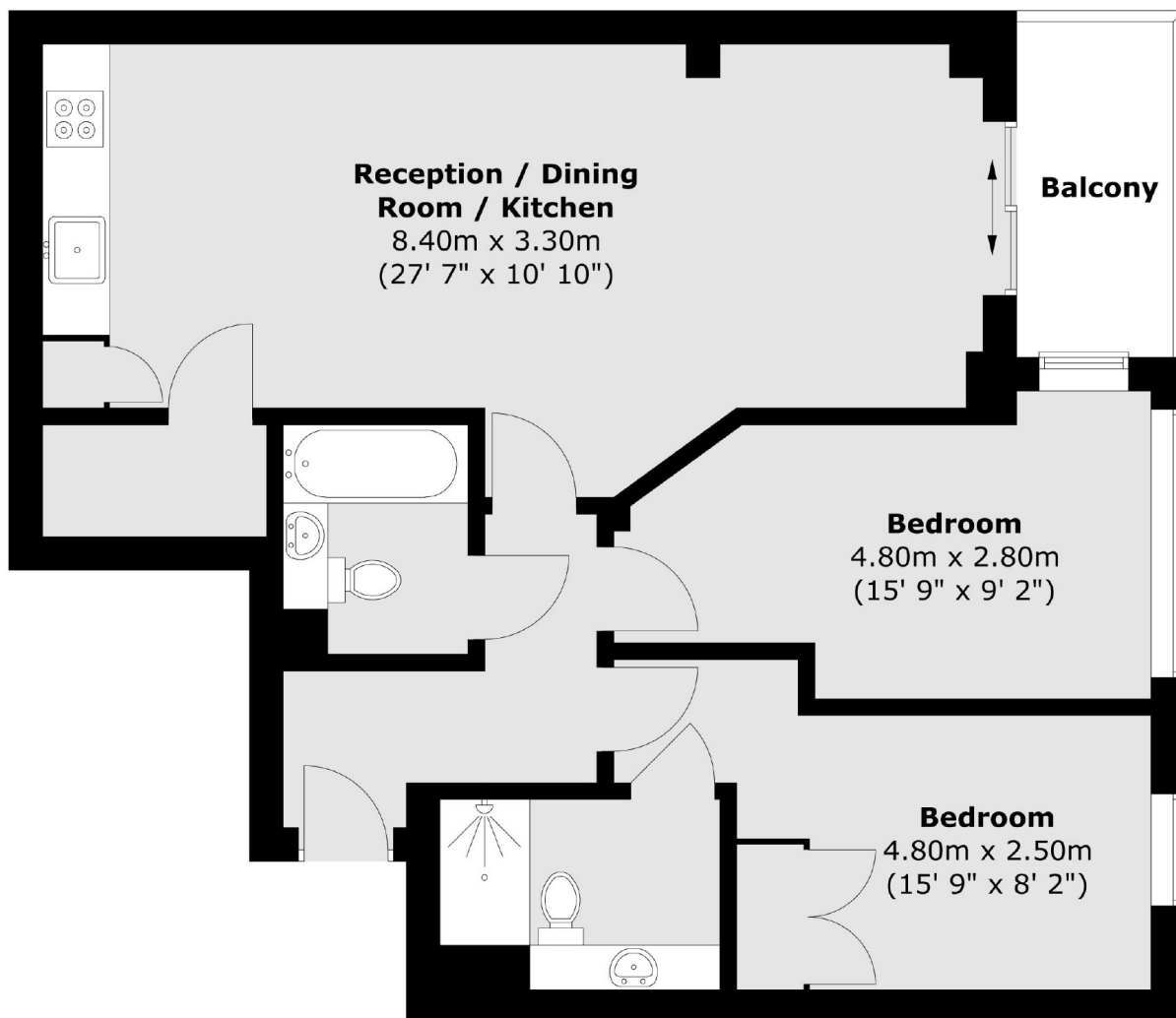

Total area (approx.) : 68.7 sq. m (739 sq. ft)  
Total balcony area (approx.) : 4.2 sq. m (45 sq. ft)