



Chronicle Avenue, NW9

£410,000

A fantastic two double bedroom apartment on the ground floor of this modern purpose-built block. Situated moments away from Colindale underground station, this delightful property benefits from two bathrooms, a private terrace and allocated parking.

Part of the "Edition" development, Chronicle Avenue is conveniently and quietly located round the corner from Colindale tube station (Northern Line).

Features

- Two Double Bedrooms
- Two Bathrooms
- Separate Kitchen
- Modern Block
- Private Terrace
- Parking

Chronicle Avenue, London, NW9

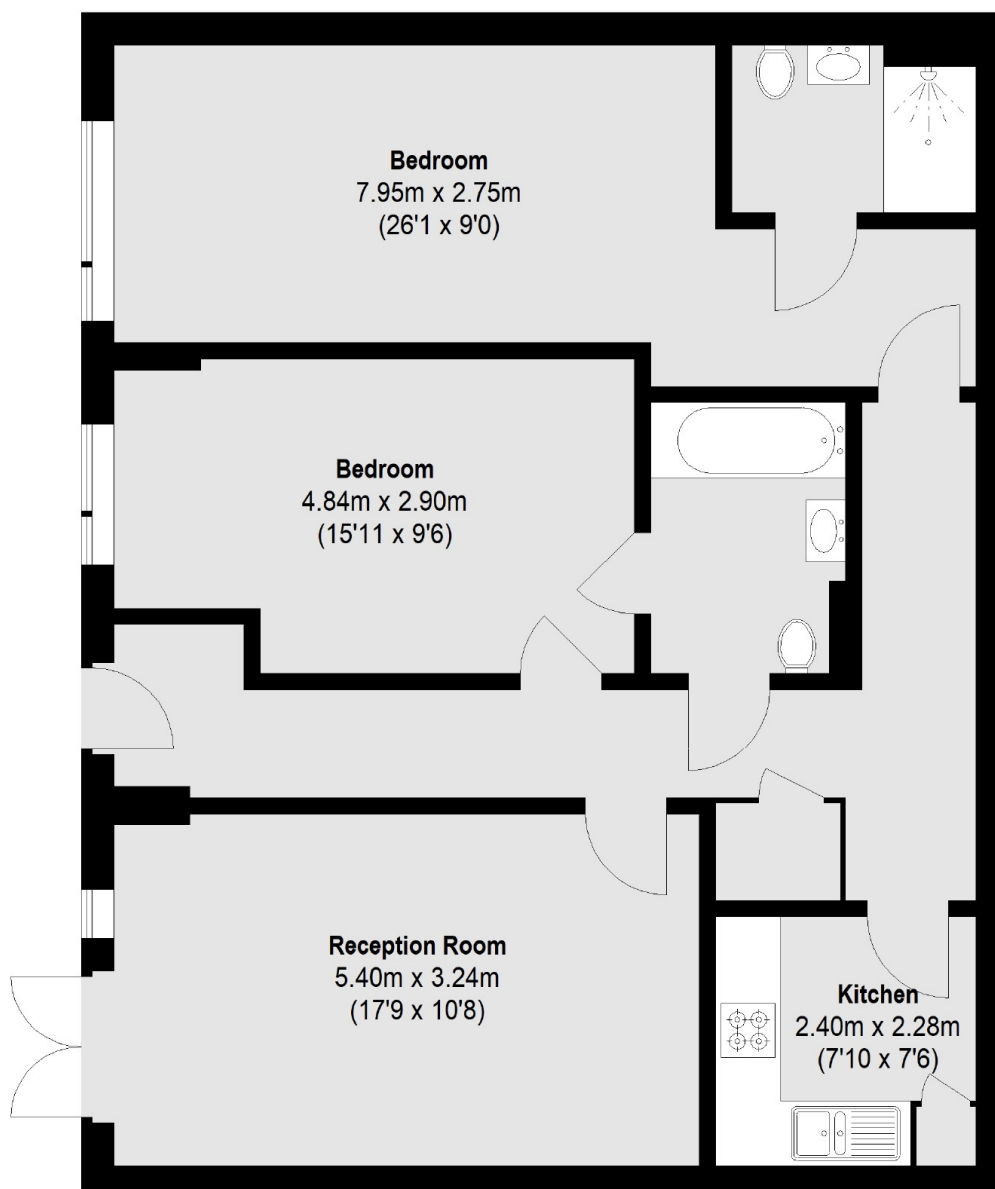

Ground Floor

Total area (approx.): 82.73 sq. m (890 Sq. ft)

Dexters

Hendon
18 Central Circus
London
NW4 3AS
Sales
020 8545 8586

Energy Rating: B. We aim to make our particulars both accurate and reliable. However they are not guaranteed; nor do they form part of an offer or contract. If you require clarification on any points then please contact us, especially if you're traveling some distance to view. Please note that appliances and heating systems have not been tested and therefore no warranties can be given as to their good working order.

 **RICS** | Regulated
Estate Agent
and Letting Agent

[dexters.co.uk](https://www.dexters.co.uk)