



Chronicle Avenue, NW9

£450,000

A fantastic two double bedroom apartment on the ground floor of this modern purpose-built block. Situated moments away from Colindale Underground Station, this delightful property benefits from two bathrooms, a private terrace and allocated parking.

Part of the "Edition" development, Chronicle Avenue is conveniently and quietly located round the corner from Colindale Tube Station (Northern Line).

Features

- Two Double Bedrooms
- Two Bathrooms
- Separate Kitchen
- Modern Block
- Private Terrace
- Parking

Chronicle Avenue, London, NW9

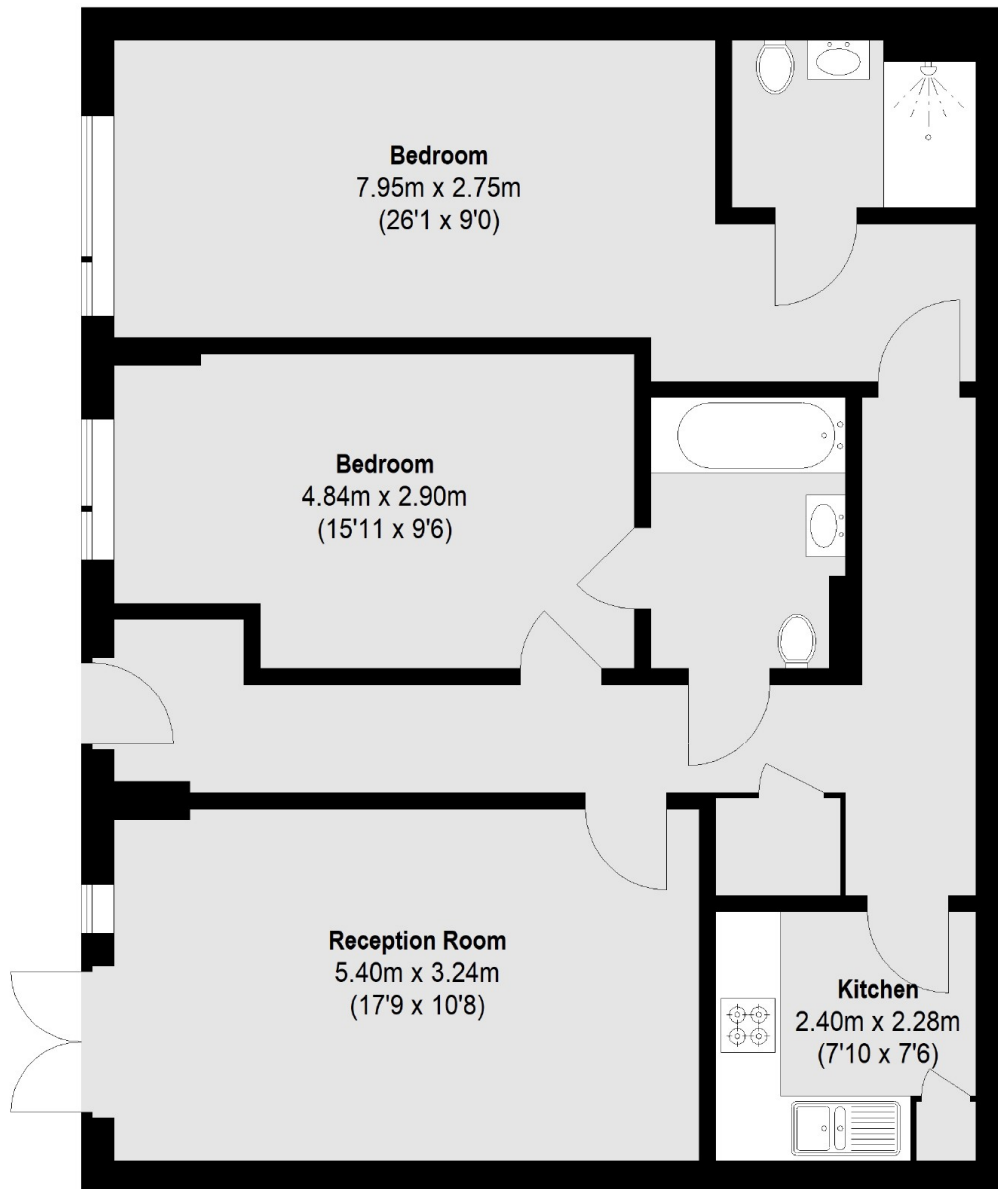

Ground Floor

Total area (approx.): 82.73 sq. m (890 Sq. ft)