



Greyhound Hill, NW4

£1,450 Per calendar month

A one double bedroom third floor apartment with lift access, consisting of a reception room with laminate floors, a private balcony, an open plan fitted kitchen, communal gardens and secure underground parking.

This apartment is within easy reach of Middlesex University and all amenities in Hendon Central, and Colindale

Features

- Third Floor Apartment
- Lift Access
- Good Condition
- Furnished
- Private Balcony
- Communal Gardens

Greyhound Hill, Hendon, NW4

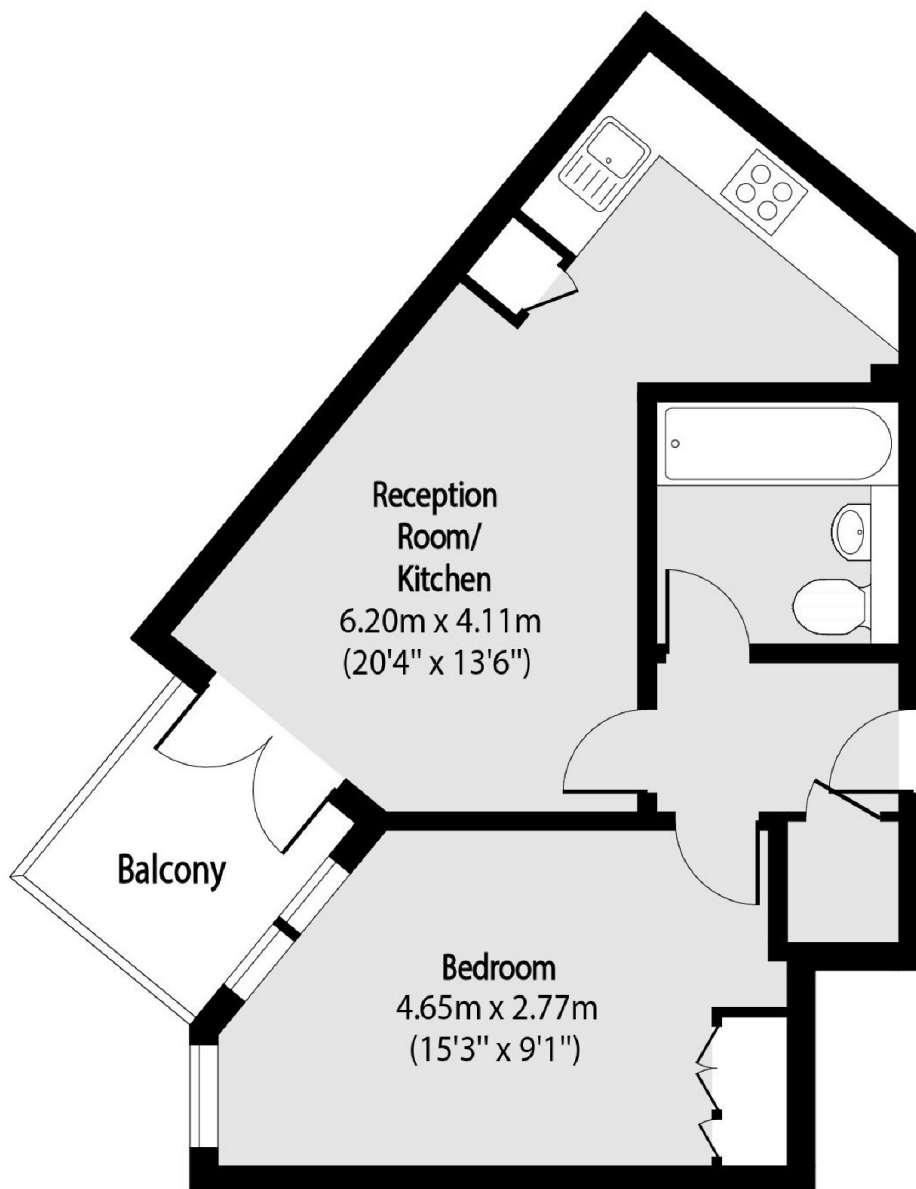

Total area (approx): 37.8 sq m (407 sq. ft)

Balcony total area (approx): 3.8 sq m (41 sq. ft)