



East Drive, NW9

£550,000

Situated within the beautiful developments of Beaufort Park is this two bedroom investment flat with a large open plan kitchen/reception. This stunning flat is in great condition, has two bathrooms and two private balconies.

Situated in the heart of Colindale and just moments from Colindale Tube Station (Northern Line) as well as numerous eateries, shops and other local amenities. Gym facilities and other transport links are also close by.

Features

- Investment Property
- Two Bathrooms
- Two Private Balconies
- Two Double Bedrooms
- Excellent Condition
- Large Kitchen/Reception

East Drive, London, NW9

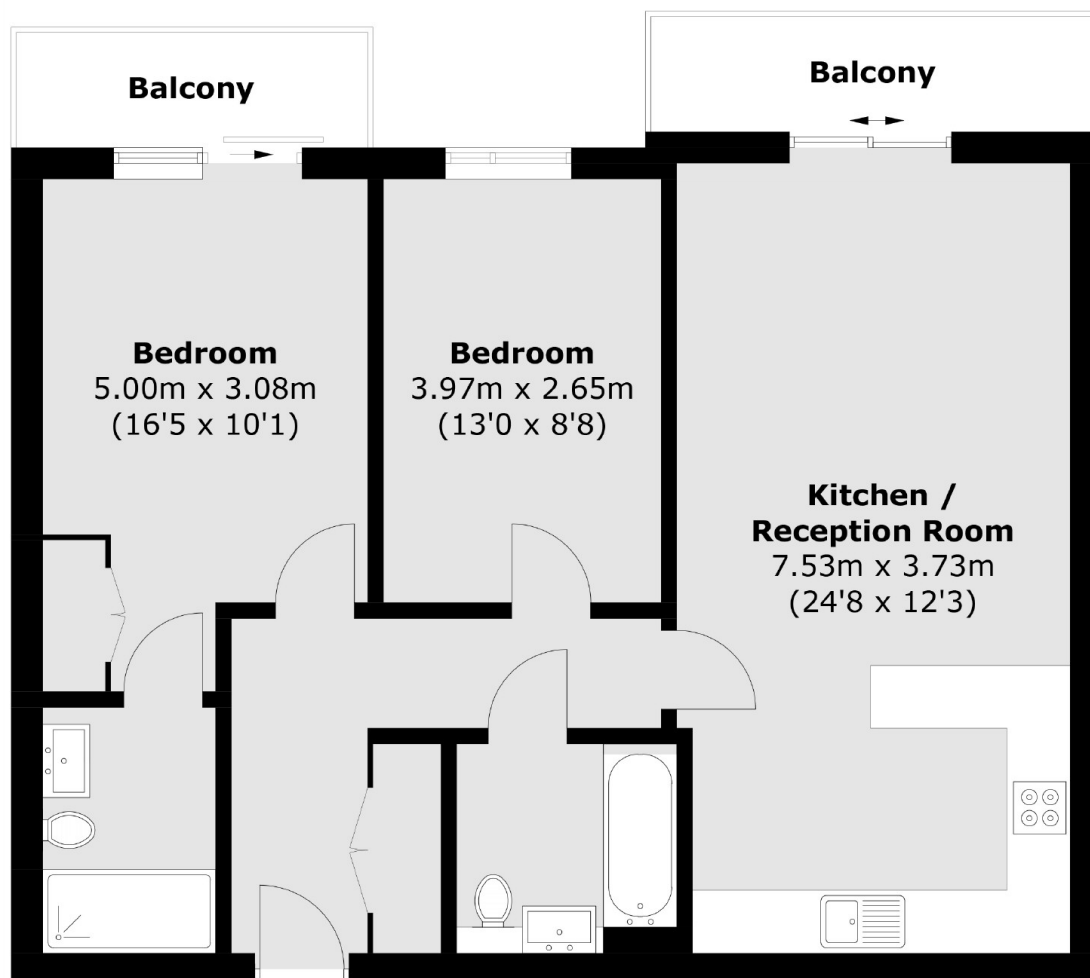

Total area (approx.): 73.6 sq. m (792.2 sq. ft)
Balconies area (approx.): 8.4 sq. m (90.4 sq. ft)