



Aerodrome Road, NW9

£375,000

A fantastic two double bedroom two bathroom flat set on the fifth floor of this modern block. This home comes with a private balcony, an underground parking space, an open-plan reception and has no chain.

Situated in the heart of Colindale and just moments from Colindale Tube Station (Northern Line) as well as numerous eateries, shops and other local amenities. Gym facilities and other transport links are also close by.

Features

- Two Double Bedrooms
- Two Bathrooms
- Private Parking
- Private Balcony
- No Chain
- Great Transport Links

Aerodrome Road, London, NW9

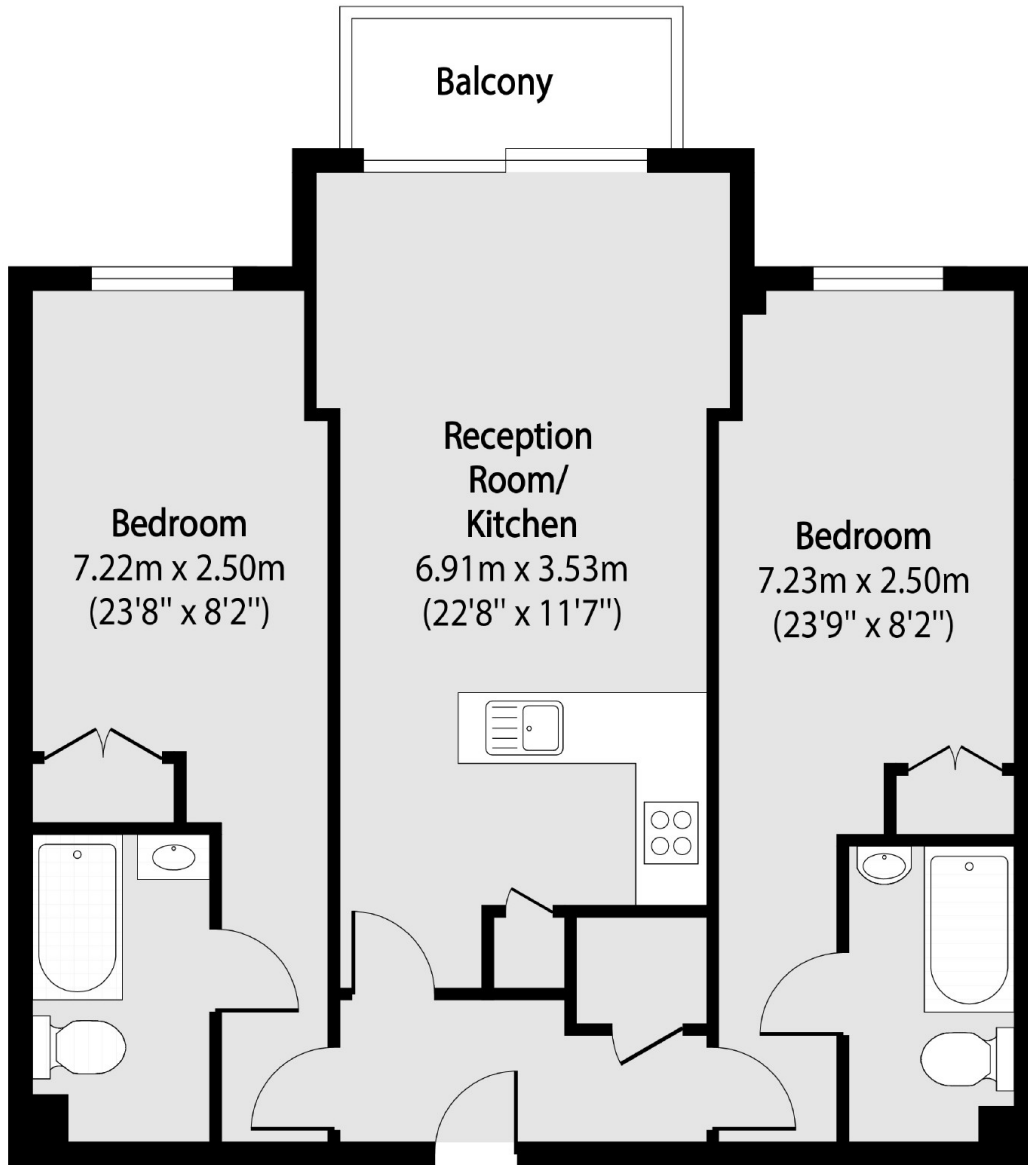

Total area (approx): 63.05 sq m (679 sq. ft)

Balcony total area (approx): 2.97 sq m (32 sq. ft)