



Manor Hall Drive, NW4

£450,000

A spacious three double bedroom flat located in Hendon on Manor Hall Drive. This home has a large lounge area, a private balcony, fitted kitchen, family bathroom and is offered chain free.

Moments from Hendon Golf Course and Cophall Playing Fields, accessible to Hendon Central and Mill Hill East Underground Station (Northern Line) and other main arterial routes.

Features

- Balcony
- Chain Free
- Share Of Freehold
- Parking
- Communal Gardens
- Purpose Built Block

Manor Hall Drive, London, NW4

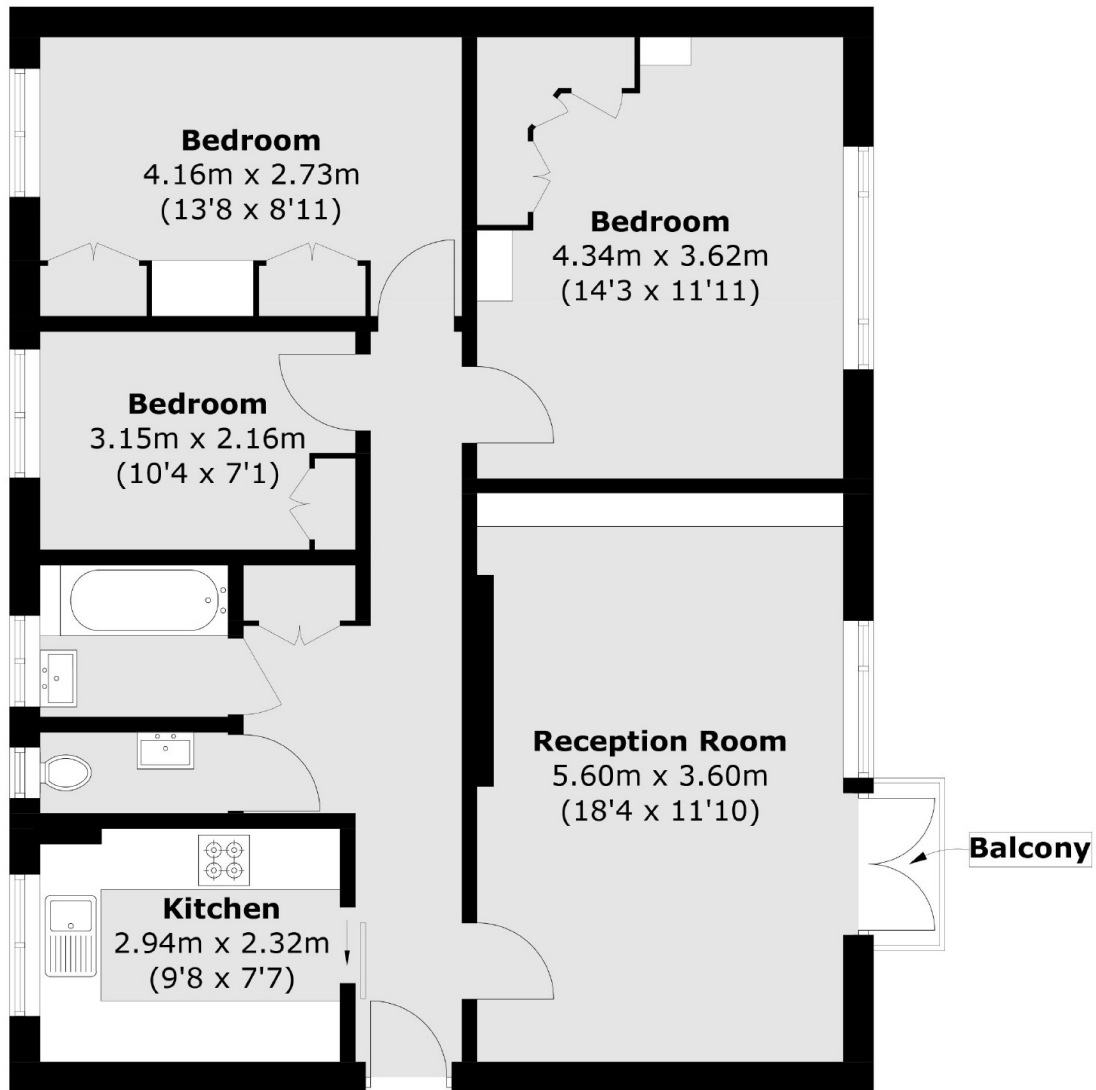

Total area (approx.): 80.1 sq. m (862.2 sq. ft)
Balcony (approx.): 1.0 sq. m (10.7 sq. ft)