



Moorhen Drive, NW9

£375,000

A fantastic quality one bedroom apartment overlooking the Welsh Harp Reservoir. There is a spacious kitchen / reception area that leads onto a private balcony, a big bedroom with ceiling to floor windows and parking.

This stunning modern development overlooks the Welsh Harp Nature Reserve and Reservoir, and is conveniently located close to Brent Cross Shopping Centre and Hendon Thameslink Station.

Features

- One Large Bedroom
- Bathroom
- Private Balcony
- Stunning Views
- Modern Apartment
- Lift Access

Moorhen Drive,
London, NW9

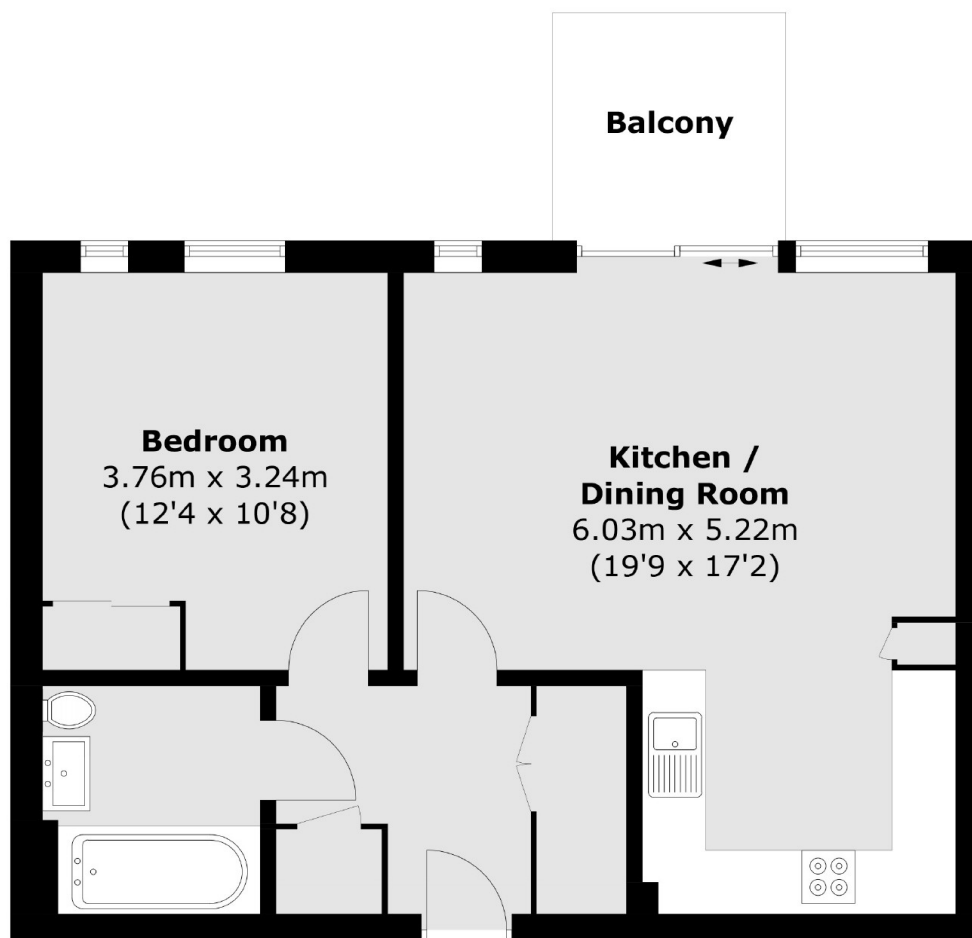

Total area (approx.): 52.4 sq. m (564.0 sq. ft)
Balcony : 4.7 sq. m (50.6 sq. ft)