



## Wheatley Close, NW4

### £300,000

A well proportioned one bedroom apartment on the ground floor of this popular block. This spacious flat benefits from a double bedroom, a separate kitchen, direct access to the communal gardens and an allocated parking space.

Wheatley Close is situated close to the Laboratory Health Club, Sunny Hill Park and main arterial routes.

### Features

- Ground Floor Flat
- Purpose-Built Block
- One Bedroom
- Separate Kitchen
- Communal Gardens
- Allocated Parking

# Wheatley Close, London, NW4

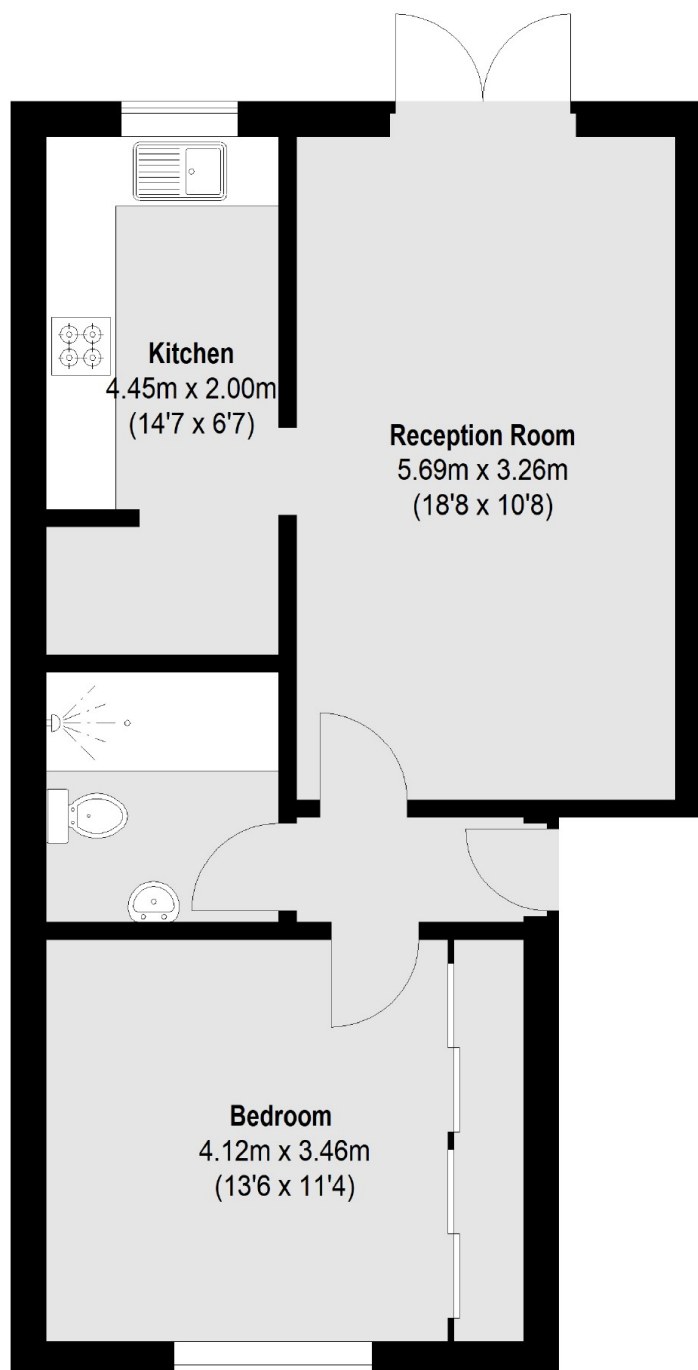

Total area (approx.): 50.32 sq. m (542 Sq. ft)

## Dexters

Hendon  
18 Central Circus  
London  
NW4 3AS  
Sales  
020 8545 8586

Energy Rating: C. We aim to make our particulars both accurate and reliable. However they are not guaranteed; nor do they form part of an offer or contract. If you require clarification on any points then please contact us, especially if you're traveling some distance to view. Please note that appliances and heating systems have not been tested and therefore no warranties can be given as to their good working order.

 **RICS** | Regulated  
Estate Agent  
and Letting Agent

[dexters.co.uk](https://www.dexters.co.uk)