



JENNINGS & BARRETT



4 Scotsdale Close

Petts Wood, BR5 1NU

£1,650,000





## Floor Plan

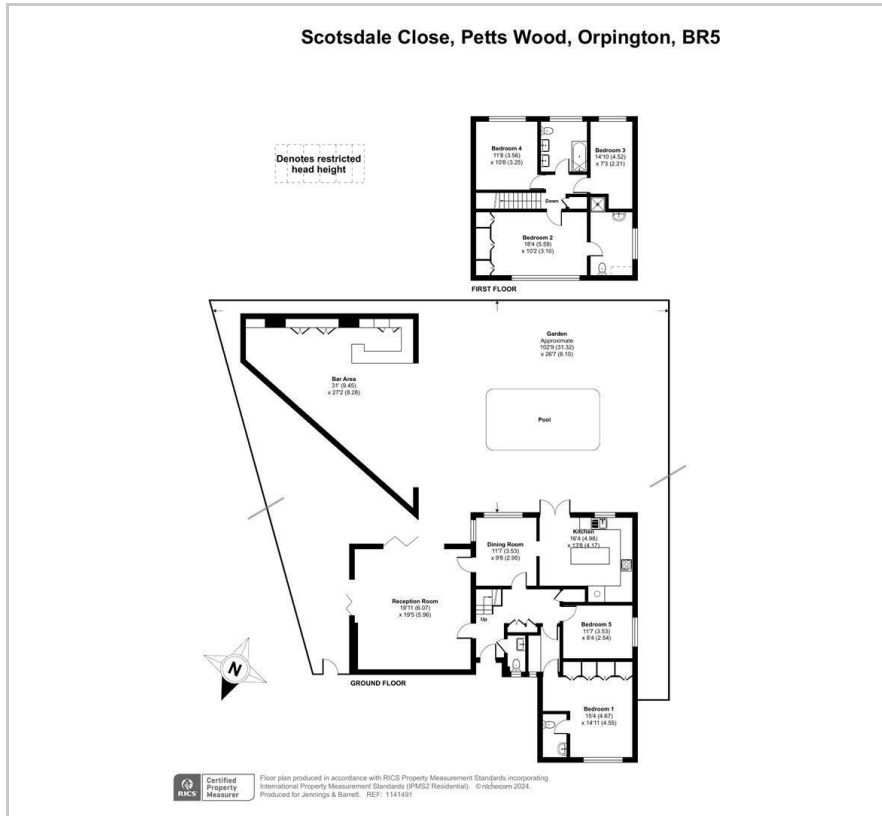

## Area Map



## Energy Efficiency Graph

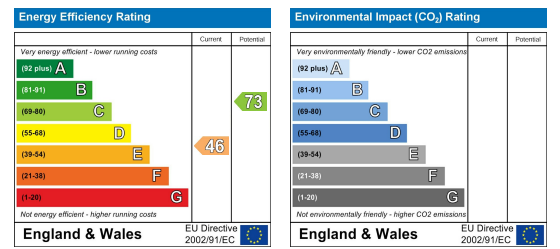

## Viewing

Please contact our Sidcup Office on 0203 598 9665 if you wish to arrange a viewing appointment for this property or require further information.

- Outstanding inside out living
- Heated pool
- Outdoor BBQ room, bar, fireplace and TV
- Private driveway for multiple cars
- Ground floor double bedroom and ensuite
- Five bedrooms
- Large duel aspect reception
- Outstanding Schools within easy reach
- Ideally located for transport links into Central London
- Residential cul de sac

Welcome to Scotsdale Close, Petts Wood - a truly remarkable property that exudes elegance. This detached house, built in 1960, boasts generous living space

Step inside this stunning home and be greeted by modern finishes that perfectly complement the classic architecture. The property has been meticulously maintained with no expense spared, ensuring a high standard of living for its future residents.

One of the standout features of this property is its spectacular outdoor living space, with heated pool & Jacuzzi offering you the opportunity to enjoy a refreshing swim all year round. Imagine hosting summer gatherings in your very own outdoor fully equipped bar and BBQ room inclusive of two fridges, ice machine, draft beer pumps, biofuel fireplace for those chilly Autumn evenings and out door TV. The garden is completely private and secure with views and sounds from the woodland behind. Whether you enjoy al fresco dining or simply basking in the sunshine, this outdoor oasis will impress.

Located in an ideal location, Scotsdale Close offers the best of both worlds - a tranquil retreat from the hustle and bustle of city life, yet within easy reach of local amenities and transport links into Central London.

Don't miss this opportunity to own a piece of paradise in Petts Wood. Contact us today to arrange a viewing and experience the beauty of this exceptional property for yourself.



These particulars, whilst believed to be accurate are set out as a general outline only for guidance and do not constitute any part of an offer or contract. Intending purchasers should not rely on them as statements of representation of fact, but must satisfy themselves by inspection or otherwise as to their accuracy. No person in this firm's employment has the authority to make or give any representation or warranty in respect of the property.

104 Station Road, Sidcup, Kent, DA15 7DE

Tel: 0203 598 9665 Email: [property@jenningsandbarrett.co.uk](mailto:property@jenningsandbarrett.co.uk) Web: [www.jenningsandbarrett.co.uk](http://www.jenningsandbarrett.co.uk)