

ParaBar Estates



St. Ediths Court, Billericay

Asking Price £300,000

- TWO BEDROOM APARTMENT
- SOUTH FACING BALCONY
- LIFT TO ALL FLOORS AND SECURITY ENTRY SYSTEM
- NO ONWARD CHAIN
- ENSUITE TO MASTER BEDROOM
- ALLOCATED PARKING SPACE
- SHORT WALK TO BILLERICAY STATION
- MODERN FITTED KITCHEN
- STONES THROW TO HIGH STREET
- 18FT LOUNGE

106 High Street, Billericay, Essex, CM12 9BY
01277 65 65 63

info@parabar.co.uk
www.parabar.co.uk

St. Ediths Court, Billericay

* LOCATION * LOCATION * LOCATION * TWO DOUBLE BEDROOMS * THIRD FLOOR FLAT * BALCONY * ENSUITE TO MASTER * HIGH STREET LOCATION * MODERN FITTED KITCHEN * ENSUITE TO MASTER * Great size two double bedroom apartment located just off the high street, with security entry system , lift to all floors and in excellent condition. This apartment is also being sold with NO ONWARD CHAIN.



Council Tax Band: D



SECURITY ENTRY DOOR

HALLWAY

LOUNGE

18 x 10'8

KITCHEN

8'5 x 8

BEDROOM ONE

16'6 x 9'5

ENSUITE

BEDROOM TWO

16 x 8

BATHROOM

7 x 5'10

BALCONY





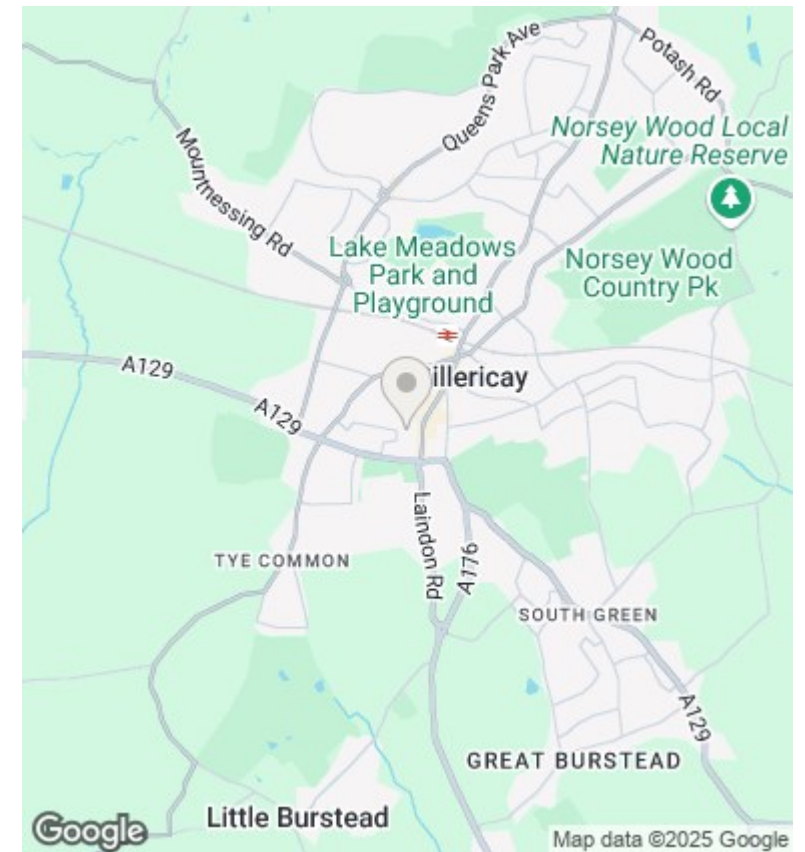
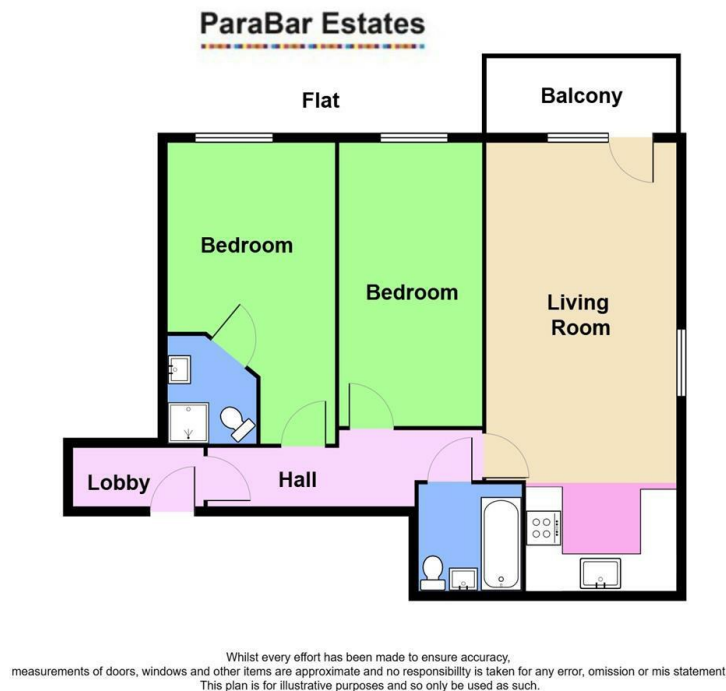

Directions

106 High Street, Billericay, Essex, CM12 9BY
01277 65 65 63

Viewings

Viewings by arrangement only. Call 01277 65 65 63 to make an appointment.

Council Tax Band

D

Energy Efficiency Rating		
	Current	Potential
Very energy efficient - lower running costs		
(92 plus) A		
(81-91) B	85	85
(69-80) C		
(55-68) D		
(39-54) E		
(21-38) F		
(1-20) G		
Not energy efficient - higher running costs		
England & Wales	EU Directive 2002/91/EC	

info@parabar.co.uk
www.parabar.co.uk