



Simmons Estates

EST: 1996



Anthony Road, Borehamwood,

£485,000

- Two Double Bedroom House
- Excellent Condition Throughout
- Potential To Extend STPP
- Ample Storage
- Separate Garage
- Large Living Room
- Popular Residential Road
- Front & Rear Garden
- Fitted Wardrobes To Master Bedroom

Situated on one of the most sought-after roads in Borehamwood, this beautifully presented two-bedroom house is within walking distance of places of worship, the mainline station, a shopping park, and all local amenities.

The property features a spacious living area, a modern kitchen, front and rear gardens, and a separate garage at the rear. It is in excellent condition throughout, located on a popular residential road, and offers ample storage space. There is also potential to extend the property, subject to planning permission (STPP).



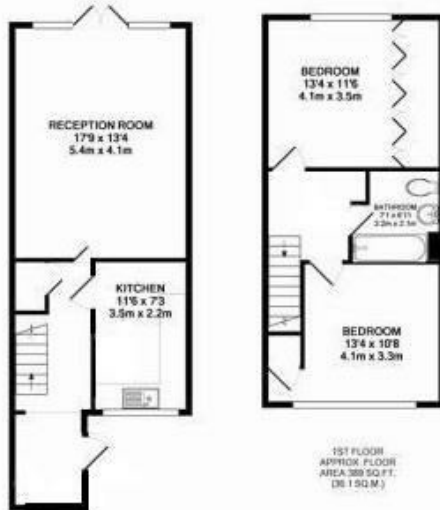

GROUND FLOOR
APPROX. FLOOR AREA 580 SQ. FT. (53.8 SQ. M.)

TOTAL APPROX. FLOOR AREA 968 SQ. FT. (89.9 SQ. M.)

Whilst every attempt has been made to ensure the accuracy of the floor plan contained here, measurements of doors, windows, rooms and any other items are approximate and no responsibility is taken for any error, omission, or misstatement. This plan is for illustrative purposes only and should be used as such by any prospective purchaser. The services, systems and appliances shown here have not been tested and no guarantee is given as to their operability or efficiency upon completion.
Made with Metreplan 102018

