



Simmons Estates

EST: 1996



Knebworth Path, Borehamwood,

£445,000

- Three Bedroom House
- Large Kitchen/Diner
- Quiet Cul-De-Sac
- Great Size Garden
- Off Street Parking
- Beautifully Presented Throughout
- South Side Of Borehamwood
- Fitted Wardrobes
- Side Access To Rear

Step into this welcoming three-bedroom home, impeccably presented throughout. The spacious kitchen/diner is the heart of the home, perfect for family gatherings and entertaining guests. Each bedroom features fitted wardrobes, offering ample storage and enhancing the home's practicality. A generously sized, well-maintained family bathroom further adds to the appeal.

Located on the south side of Borehamwood, this property offers the tranquility of a quiet cul-de-sac while still providing easy access to local amenities. With side access and off-street parking, convenience is at your doorstep. Enjoy the ideal blend of comfort, functionality, and serenity in this charming Borehamwood residence.



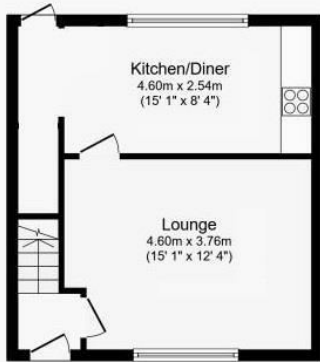

Ground Floor

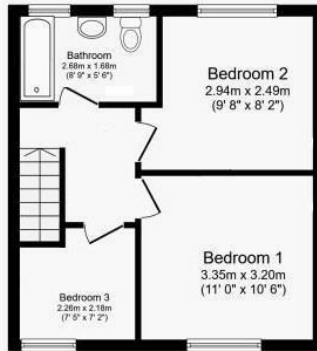

First Floor

