



**25a Alexandra Road, Borehamwood, Hertfordshire, WD6 5PB**  
**£750,000**

A four-bedroom detached house situated on a fantastic road. The property has a very large lounge/diner, a TV/Family area, two bath/shower rooms, a downstairs toilet, and an integral garage which has the potential to convert (subject to planning). The property is positioned on a quiet road, with on-street parking, and a large rear garden.



### Ground Floor

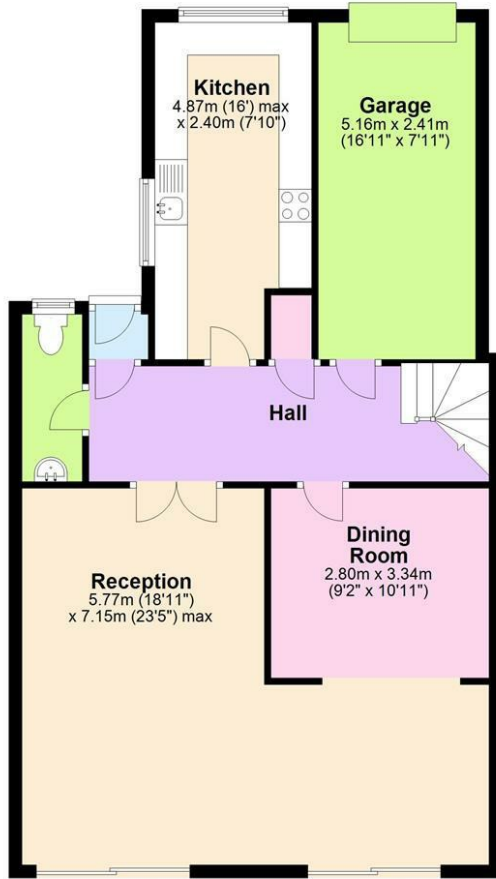

### First Floor



Total area: approx. 143.0 sq. metres (1539.1 sq. feet)

The measurements given are approximate and are for illustration only. They should not be relied on for valuation. Plan produced using PlanUp.

Energy Efficiency Rating		Current	Potential
Very energy efficient - lower running costs			
(92 plus) <b>A</b>			
(81-91) <b>B</b>			
(69-80) <b>C</b>			
(55-68) <b>D</b>		<b>63</b>	<b>80</b>
(39-54) <b>E</b>			
(21-38) <b>F</b>			
(1-20) <b>G</b>			
Not energy efficient - higher running costs			
England & Wales		EU Directive 2002/91/EC	