



OAKFIELD



Weavers Close, Eastbourne.

£1,500 Per Calendar Month



Weavers Close, Eastbourne.

This four-bedroom terrace townhouse is located within walking distance to the hospital and Sussex Downs College whilst shops and other local amenities are only a short walk or bus ride into the town centre, seafront and train station with direct links into London and Brighton.

Comprising of a spacious entrance hall, downstairs WC and utility room equipped with a washing machine and storage cupboards. The spacious living room is open plan with kitchen/dining and is fitted with a range of modern base and eye level units, integrated oven, hob, extractor hood, fridge/freezer, dishwasher and stainless steel sink with drainer.

The bedrooms are spread across two floors and are all doubles. The master further benefits from an ensuite.

Further perks include a low maintenance rear garden which is mainly laid to lawn, off road covered parking for two vehicles, gas central heating and within the development there is a children's play area.

Please note:

An annual household income of £45,000 is required to pass the affordability requirements

The tenancy will begin with a 12 month initial term.

Kitchen/Living Room

32'1" x 14'5" (9.8 x 4.4)

Bedroom One

16'0" x 14'5" (4.9 x 4.4)

Ensuite

Bedroom Two

13'5" x 7'10" (4.1 x 2.4)





Bedroom Three
14'5" x 11'5" (4.4 x 3.5)

Bedroom Four
13'1" x 7'6" (4.0 x 2.3)

Bathroom

Council Tax Band E - £2953



Floor Plan

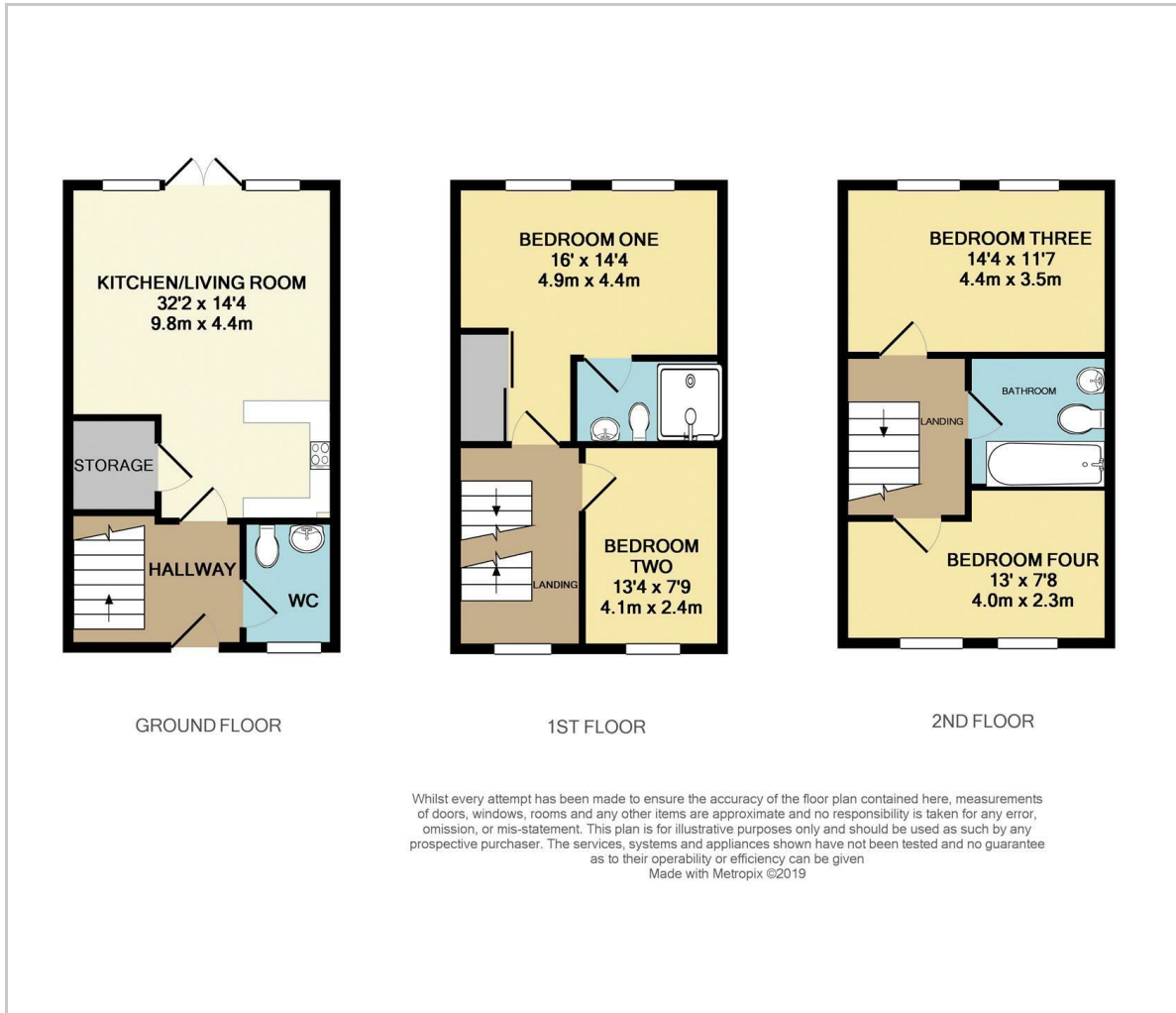

Viewing

Please contact us on 01323 405553 if you wish to arrange a viewing appointment for this property or require further information.

These particulars, whilst believed to be accurate are set out as a general outline only for guidance and do not constitute any part of an offer or contract. Intending purchasers should not rely on them as statements of representation of fact, but must satisfy themselves by inspection or otherwise as to their accuracy. No person in this firm's employment has the authority to make or give any representation or warranty in respect of the property.

Area Map



Energy Efficiency Graph

