



# Arc House

16 Maltby Street, SE1

£2,000 per month  
(£461.54 per week)

A superb contemporary one bedroom apartment set within a modern development in enviable London Bridge location within easy reach of the many bars and restaurants of Bermondsey Street and Shad Thames.

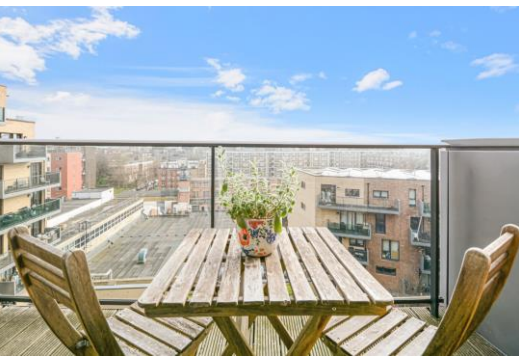

# Arc House

16 Maltby Street, SE1

- ONE BEDROOM
- OPEN PLAN
- MODERN BATHROOM
- BALCONY



A superb contemporary one bedroom apartment set within a modern development in enviable London Bridge location within easy reach of the many bars and restaurants of Bermondsey Street and Shad Thames.

**Minimum Term:** 12 months  
**Deposit Required:** £2,307.69  
**Local Authority:** London Borough of Southwark (Council Tax)  
**Council Tax Band:** D  
**EPC Rating:** B  
**Furnished**

Energy Efficiency Rating		
	Current	Potential
Very energy efficient - lower running costs		
(92-100) <b>A</b>		
(81-91) <b>B</b>	86	86
(69-80) <b>C</b>		
(55-68) <b>D</b>		
(39-54) <b>E</b>		
(21-38) <b>F</b>		
(1-20) <b>G</b>		
Not energy efficient - higher running costs		
England, Scotland & Wales EU Directive 2002/91/EC		

### Chestertons Tower Bridge Lettings

220 Tower Bridge Road  
 Tower Bridge  
 London  
 SE1 2UP  
 towerbridge@chestertons.co.uk  
 02073576911  
 chestertons.co.uk

Additional tenant charges apply (fees apply to non-AST tenancies only)  
 Tenancy Agreement Fee: £300  
 References per Tenant/Guarantor: £60  
 Inventory check (approx. £100 – £250 inc. VAT)  
 chestertons.co.uk/property-to-rent/applicable-fees



# Arc House, SE1

Approx. Gross Internal Area 500 Sq Ft - 46.45 Sq M  
Approx. Gross Balcony Area 47 Sq Ft - 4.37 Sq M

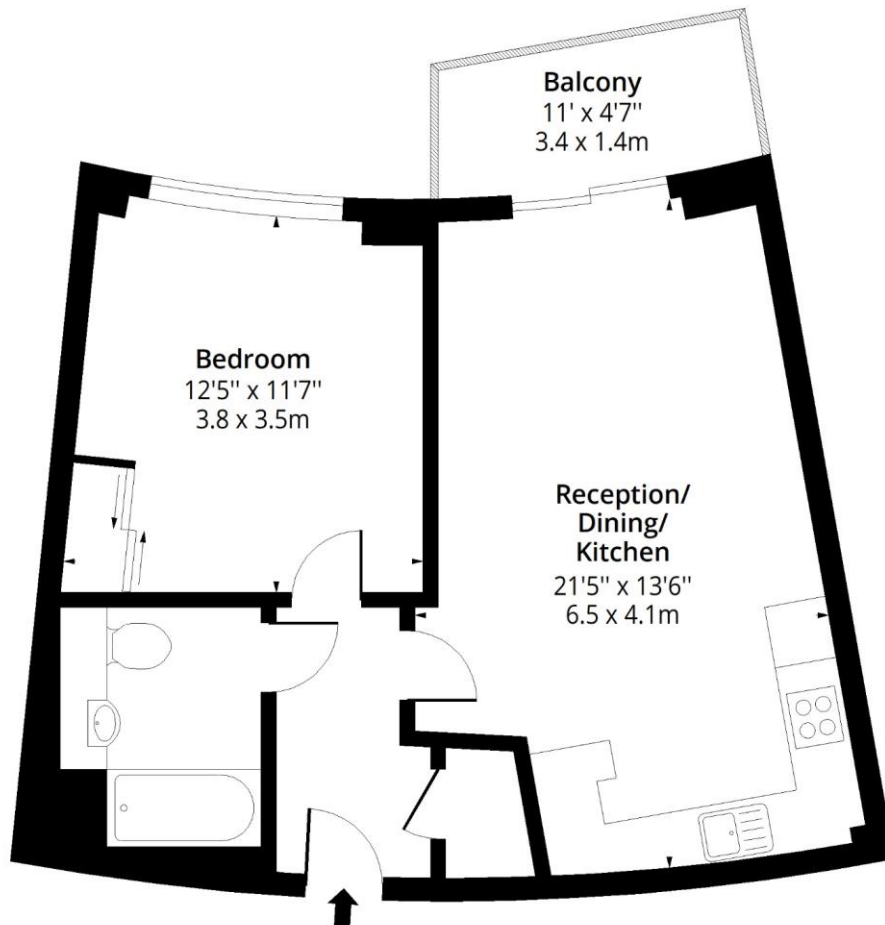

## Seventh Floor

Floor Area 500 Sq Ft - 46.45 Sq M



Measured according to RICS IPMS2. Floor plan is for illustrative purposes only and is not to scale. Every attempt has been made to ensure the accuracy of the floor plan shown, however all measurements, fixtures, fittings and data shown are an approximate interpretation for illustrative purposes only. 1 sq m = 10.76 sq feet.

[lpaplus.com](https://www.lpaplus.com)

Date: 11/3/2024



This paper is  
100% recyclable