



Keats Close

London, SE1

£4,350 per month
(£1,003.85 per week)

A modern house situated at the end of this cul-de-sac close to Old Kent Road. Accommodation arranged over three floors comprising: open plan reception/kitchen, 5 bedrooms, 2 bathrooms, separate WC, garden and off street parking.

CHESTERTONS



Keats Close

London, SE1

- HOUSE
- FIVE BEDROOM
- TWO BATHROOMS
- GARDEN
- FURNISHED



A modern house situated at the end of this cul-de-sac close to Old Kent Road. Accommodation arranged over three floors comprising: open plan reception/kitchen, 5 bedrooms, 2 bathrooms, separate WC, garden and off street parking.

Minimum Term: 12 months
Deposit Required: £5,019.23
Local Authority: London Borough of Southwark
Council Tax Band: E
EPC Rating: C
Furnished

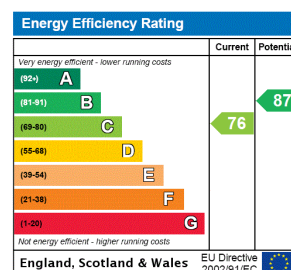

Chestertons Tower Bridge Lettings

220 Tower Bridge Road
 Tower Bridge
 London
 SE1 2UP
 towerbridge@chestertons.co.uk
 02073576911
 chestertons.co.uk

Additional tenant charges apply (fees apply to non-AST tenancies only)
 Tenancy Agreement Fee: £300
 References per Tenant/Guarantor: £60
 Inventory check (approx. £100 – £250 inc. VAT)
 chestertons.co.uk/property-to-rent/applicable-fees

Keats Close, SE1

Approx. Gross Internal Area 1242 Sq Ft - 115.38 Sq M

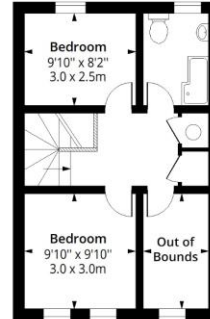
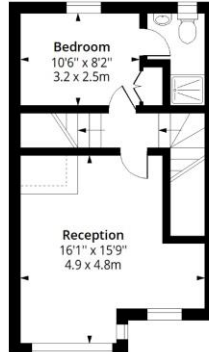
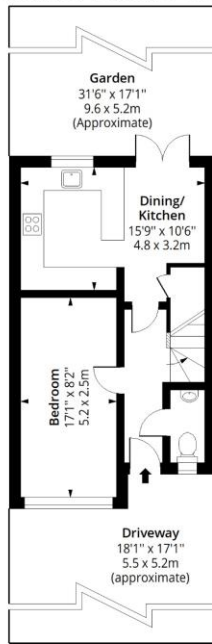

Measured according to RICS IPMS2. Floor plan is for illustrative purposes only and is not to scale. Every attempt has been made to ensure the accuracy of the floor plan shown, however all measurements, fixtures, fittings and data shown are an approximate interpretation for illustrative purposes only. 1 sq m = 10.76 sq feet.

lpaplus.com

Date: 1/7/2024



This paper is
100% recyclable