



# Crimscott Street

London, SE1

£3,750 per month  
(£865.38 per week)

Set on the top floor of a striking boutique development in SE1, this 2 bed 2 bath apartment measures approx 840sqft of internal space, with a large private terrace. The development also benefits from residents roof terrace.

CHESTERTONS



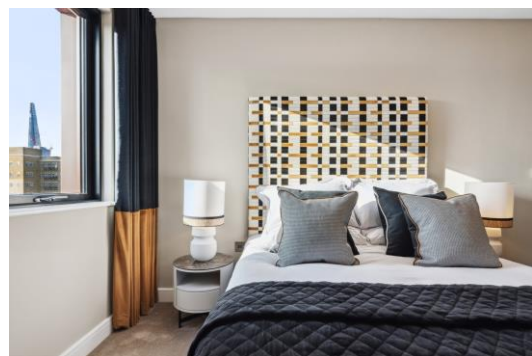

# Crimscott Street

London, SE1

- NEW BUILD
- TWO BEDROOMS
- TWO BATHROOMS
- FURNISHED/UNFURNISHED



Set on the top floor of a striking boutique development in SE1, this 2 bed 2 bath apartment measures approx 840sqft of internal space, with a large private terrace. The development also benefits from residents roof terrace.

**Minimum Term:** 12 months  
**Deposit Required:** £0.00  
**Local Authority:** London Borough of Southwark  
**Council Tax Band:** E  
**EPC Rating:** C  
**Furnished, Unfurnished**

Score	Energy rating	Current	Potential
92+	A		
81-91	B		
69-80	C	71 C	71 C
55-68	D		
39-54	E		
21-38	F		
1-20	G		

### *Chestertons Tower Bridge Lettings*

220 Tower Bridge Road  
 Tower Bridge  
 London  
 SE1 2UP  
 towerbridgelettingsusers@chestertons.co.uk  
 02073576911  
 chestertons.co.uk

Additional tenant charges apply (fees apply to non-AST tenancies only)  
 Tenancy Agreement Fee: £300  
 References per Tenant/Guarantor: £60  
 Inventory check (approx. £100 – £250 inc. VAT)  
 chestertons.co.uk/property-to-rent/applicable-fees



# APARTMENT 09

## 2 BED

### TOTAL AREA

78 m<sup>2</sup>

841 sqft

### EXTERNAL

7 m<sup>2</sup>

75 sqft

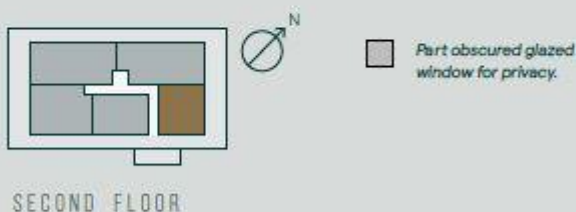

### KITCHEN / LIVING / DINING

7.03m x 5.45m

23'1" x 17'11"

### BEDROOM 1

6.41m x 2.75m

21' x 9'

### BEDROOM 2

4.81m x 2.55m

15'9" x 8'4"

Plans not to scale.

For indicative purposes only.

