



Chamberlain House

126 Westminster Bridge Road, SE1

£2,166.67 per month
(£500 per week)

A contemporary one bedroom apartment comprises a double bedroom with built-in wardrobes, reception with wood floors and a door to a private balcony, tiled bathroom with shower-over-bath and a kitchen with integrated appliances.



Chamberlain House

126 Westminster Bridge Road, SE1

- MODERN
- ONE BEDROOM
- FURNISHED



A contemporary one bedroom apartment located within a portered building and only minutes walking distance to Lambeth North Underground Station. The apartment comprises a double bedroom with built-in wardrobes, reception with wood floors and a door to a private balcony, tiled bathroom with shower-over-bath and a kitchen with integrated appliances.

Minimum Term: 12 months
Deposit Required: £2,500.00
Local Authority: Lambeth
Council Tax Band: E
EPC Rating: D
Furnished

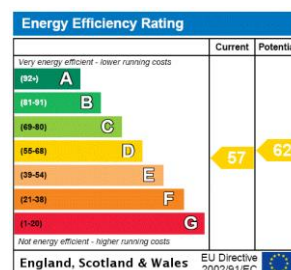

Chestertons Tower Bridge Lettings

220 Tower Bridge Road
 Tower Bridge
 London
 SE1 2UP
 towerbridge@chestertons.co.uk
 02073576911
 chestertons.co.uk

Additional tenant charges apply (fees apply to non-AST tenancies only)
 Tenancy Agreement Fee: £300
 References per Tenant/Guarantor: £60
 Inventory check (approx. £100 – £250 inc. VAT)
 chestertons.co.uk/property-to-rent/applicable-fees

Chamberlain House, SE1

Approx. Gross Internal Area 507 Sq Ft - 47.10 Sq M

Approx. Gross Balcony Area 50 Sq Ft - 4.65 Sq M

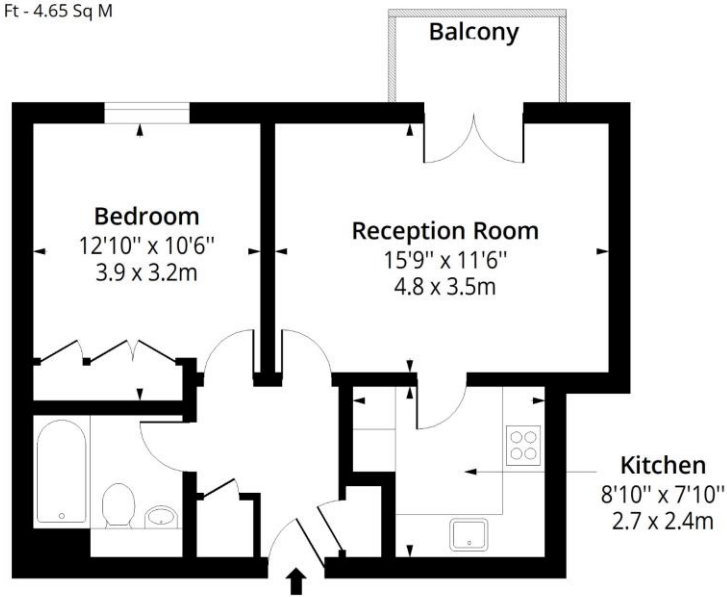

Raised Ground Floor

Floor Area 507 Sq Ft - 47.10 Sq M



Measured according to RICS IPMS2. Floor plan is for illustrative purposes only and is not to scale. Every attempt has been made to ensure the accuracy of the floor plan shown, however all measurements, fixtures, fittings and data shown are an approximate interpretation for illustrative purposes only. 1 sq m = 10.76 sq feet.

lpaplus.com

Date: 11/8/2023



This paper is
100% recyclable