



Gainsford Street

London, SE1

£2,500 per month
(£576.92 per week)

A charming two bedroom house in the heart of Shad Thames. The property boasts a separate kitchen, spacious reception room with doors that lead onto a private garden, two double bedrooms and bathroom.

CHESTERTONS



Gainsford Street

London, SE1

- Two Bedroom House
- Shad Thames Location
- Private Garden
- Private Parking Space



A charming two bedroom house in the heart of Shad Thames. The property boasts a separate kitchen, spacious reception room with doors that lead onto a private garden, two double bedrooms and bathroom.

Shad Thames is a unique area steeped in history and character situated along the south side of the River Thames. The area is home to London's most iconic landmark, Tower Bridge and is within the vicinity of many attractions such as The Shard, Tate Modern and Tower of London. Shad Thames boasts a variety of bars and restaurants and is a short walk to the delights of Bermondsey Street, Maltby Street & Borough markets. Although The City is within walking distance the area is well connected with excellent transport links via London Bridge & Tower Hill stations as well as the river taxi.

Minimum Term:	12 months
Deposit Required:	£2,884.62
Local Authority:	London Borough of Southwark (Council Tax)
Council Tax Band:	E
EPC Rating:	C
Furnished, Unfurnished	

Chestertons Tower Bridge Lettings

220 Tower Bridge Road
Tower Bridge
London
SE1 2UP
towerbridge@chestertons.co.uk
02073576911
chestertons.co.uk

Additional tenant charges apply (fees apply to non-AST tenancies only)
Tenancy Agreement Fee: £300
References per Tenant/Guarantor: £60
Inventory check (approx. £100 – £250 inc. VAT)
[chestertons.co.uk/property-to-rent/applicable-fees](https://www.chestertons.co.uk/property-to-rent/applicable-fees)

Gainsford Street, SE1

Approx. Gross Internal Area 610 Sq Ft - 56.67 Sq M

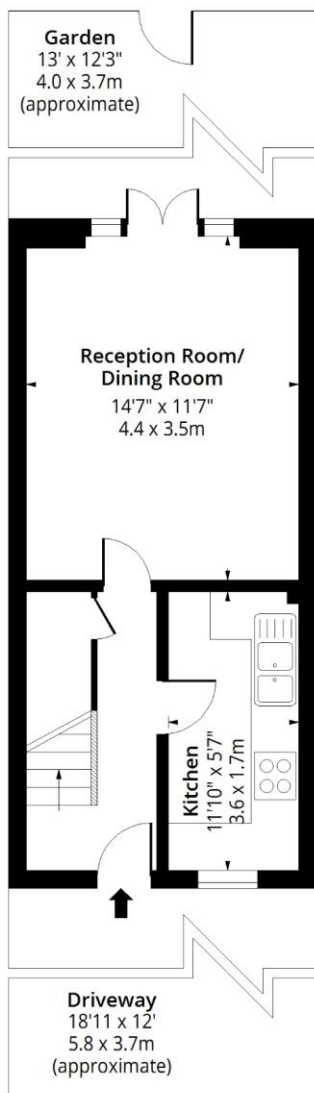

Ground Floor

Floor Area 305 Sq Ft - 28.33 Sq M

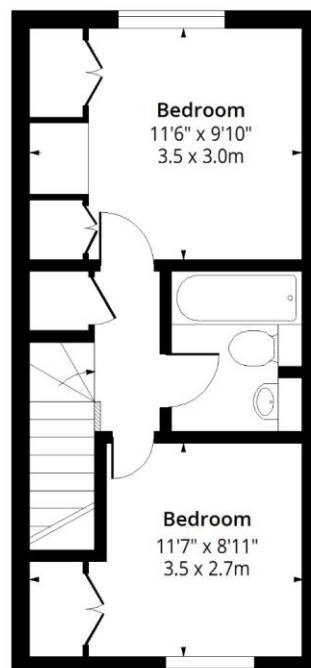

First Floor

Floor Area 305 Sq Ft - 28.33 Sq M

Floor plan is for illustrative purposes only and is not to scale. Every attempt has been made to ensure the accuracy of the floor plan shown, however all measurements, fixtures, fittings and data shown are an approximate interpretation for illustrative purposes only.

lpaplus.com



This paper is
100% recyclable