



# Fallow Court

Argyle Way, SE16

£2,900 per month  
(£669.23 per week)

MAX 3 SHARERS \* Four bedroom house in prime location. Modern design, spacious rooms, and close to amenities. Perfect for families or professionals.



# Fallow Court

Argyle Way, SE16

- MAX 3 SHARERS
- Four bedrooms
- Conservatory
- Private garden





MAX 3 SHARERS \* Four bedroom house in prime location. Modern design, spacious rooms, and close to amenities. Perfect for families or professionals.

---

**Minimum Term:** 12 months  
**Deposit Required:** £3,346.15  
**Local Authority:**  
**Council Tax Band:**  
**EPC Rating:** C  
**Furnished**

---

### *Chestertons Tower Bridge Lettings*

220 Tower Bridge Road  
Tower Bridge  
London  
SE1 2UP  
towerbridge@chestertons.co.uk  
02073576911  
chestertons.co.uk

Additional tenant charges apply (fees apply to non-AST tenancies only)  
Tenancy Agreement Fee: £300  
References per Tenant/Guarantor: £60  
Inventory check (approx. £100 – £250 inc. VAT)  
[chestertons.co.uk/property-to-rent/applicable-fees](https://www.chestertons.co.uk/property-to-rent/applicable-fees)

# Fallow Court, SE16

Approx. Gross Internal Area 878 Sq Ft - 81.57 Sq M

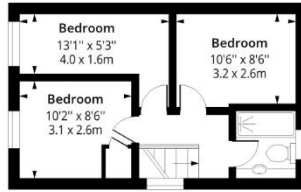

## First Floor

Floor Area 350 Sq Ft - 32.52 Sq M

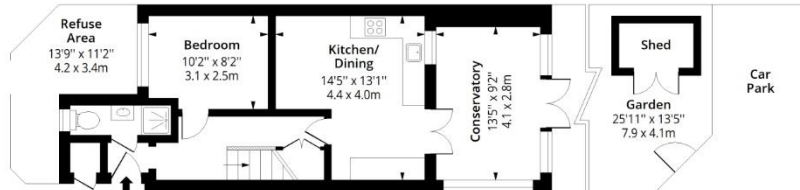

## Ground Floor

Floor Area 528 Sq Ft - 49.05 Sq M



Measured according to RICS IPMS2. Floor plan is for illustrative purposes only and is not to scale. Every attempt has been made to ensure the accuracy of the floor plan shown, however all measurements, fixtures, fittings and data shown are an approximate interpretation for illustrative purposes only. 1 sq m = 10.76 sq feet.

lpaplus.com

Date: 26/8/2024

