



Steedman Street

London, SE17

£2,500 per month
(£576.92 per week)

A spacious two bedroom flat available immediately. The property comprises two double bedrooms, modern bathroom, open plan living space/kitchen and large balcony.



Steedman Street

London, SE17

- UNFURNISHED
- TWO BEDROOMS
- MODERN BATHROOM
- BALCONY



A spacious two bedroom flat available immediately. The property comprises two double bedrooms, modern bathroom, open plan living space/kitchen and large balcony.

Minimum Term: 12 months
Deposit Required: £2,884.62
Local Authority: London Borough of Southwark
Council Tax Band: C
EPC Rating: To be confirmed
Furnished, Unfurnished

Chestertons Tower Bridge Lettings

220 Tower Bridge Road
Tower Bridge
London
SE1 2UP
towerbridge@chestertons.co.uk
02073576911
chestertons.co.uk

Additional tenant charges apply (fees apply to non-AST tenancies only)
Tenancy Agreement Fee: £300
References per Tenant/Guarantor: £60
Inventory check (approx. £100 – £250 inc. VAT)
[chestertons.co.uk/property-to-rent/applicable-fees](https://www.chestertons.co.uk/property-to-rent/applicable-fees)

Steedman Street, SE17

Approx. Gross Internal Area 695 Sq Ft - 64.57 Sq M
Approx. Gross Balcony Area 123 Sq Ft - 11.43 Sq M

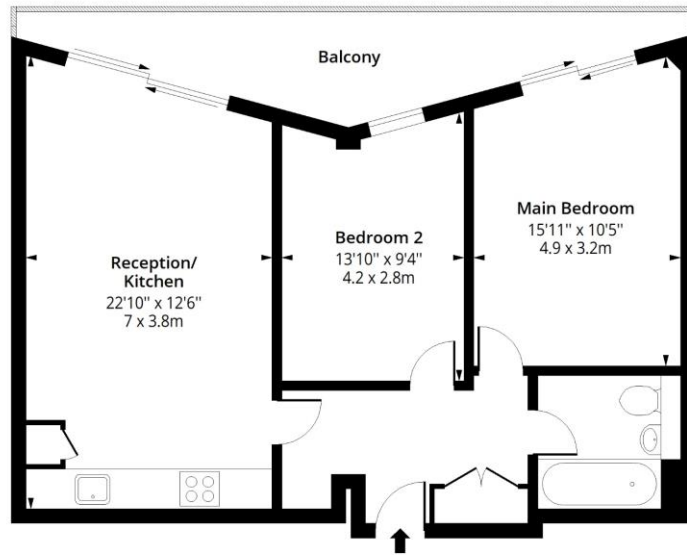

First Floor

Floor Area 695 Sq Ft - 64.57 Sq M



Measured according to RICS IPMS2. Floor plan is for illustrative purposes only and is not to scale. Every attempt has been made to ensure the accuracy of the floor plan shown, however all measurements, fixtures, fittings and data shown are an approximate interpretation for illustrative purposes only. 1 sq m = 10.76 sq feet.

lpaplus.com

Date: 25/6/2024

