



0/2, 39 LOCHLEVEN ROAD
BATTLEFIELD

www.corumproperty.co.uk



2 | BEDROOMS
1 | BATHROOM
1 | PUBLIC ROOM

A stunning ground floor flat, set in the heart of the battlefield community, offering a modern specification and terrific enclosed private gardens to the front.

- Popular Battlefield address
- Private front garden
- Bay window lounge
- Two double sized bedrooms
- Modern kitchen and bathroom
- Open aspects to the front

Amenities

39 Lochleven Road is within walking distance of many local amenities including coffee houses, restaurants, bars and bakeries. Regular public transport services are available nearby with Mount Florida train station only 500 yards from the front door and bus routes on Battlefield Road.

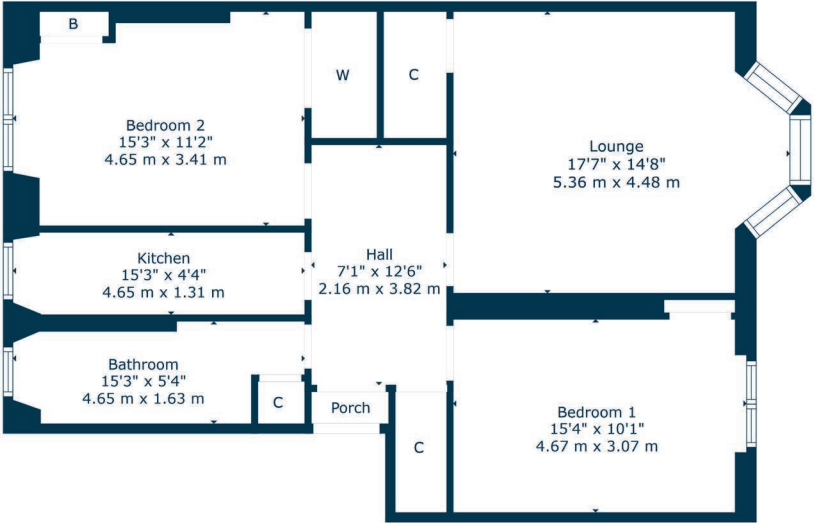

Sat Nav:
0/2, 39 Lochleven Road, Battlefield, G42 9QT

SS5044

*All measurements and distances are approximate.
Floorplans are for illustration purposes and may not be to scale.

For the full home report visit
www.corumproperty.co.uk



WE'RE **SOLD** ON
YOUR FUTURE



Corum Shawlands
247 Kilmarnock Road, Shawlands, G41 3JF

Tel: 0141 636 7588
Email: shawlands@corumproperty.co.uk

www.corumproperty.co.uk