



## 5 WOLSELEY TERRACE

OATLANDS

[www.corumproperty.co.uk](http://www.corumproperty.co.uk)



2 | BEDROOMS  
1 | BATHROOM  
1 | PUBLIC ROOM

A well presented mid terrace set within the popular Oatlands development, close to motorway links and parks.

- Mid terrace villa
- 2 bedrooms (with storage)
- Lounge open plan to kitchen
- Bi-fold doors to garden
- Driveway parking
- Modern bathroom and WC

Amenities

The Oatlands district is well positioned to take full advantage of the excellent choice of amenities available within the area which include Richmond Park, further to Glasgow Green, a range of local shops and health and leisure facilities. The M74 motorway links nicely to the Glasgow motorway network for those travelling further afield.

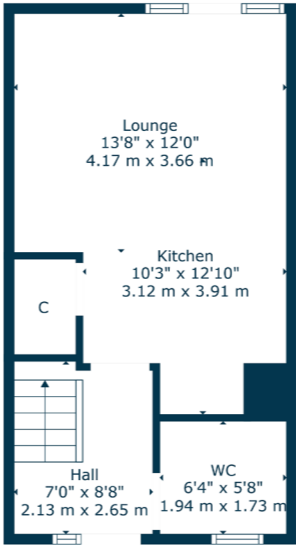

Ground Floor

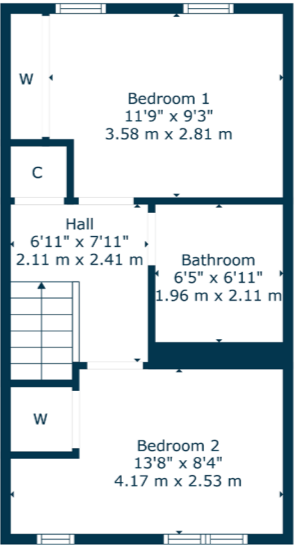

1st Floor

Sat Nav:  
5 Wolseley Terrace, Oatlands, G5 0LS

SS5023

\*All measurements and distances are approximate.  
Floorplans are for illustration purposes and may not be to scale.

For the full home report visit  
[www.corumproperty.co.uk](http://www.corumproperty.co.uk)



WE'RE **SOLD** ON  
YOUR FUTURE



Corum Shawlands  
247 Kilmarnock Road, Shawlands, G41 3JF

**Tel:** 0141 636 7588

**Email:** shawlands@corumproperty.co.uk

[www.corumproperty.co.uk](http://www.corumproperty.co.uk)