



**FLAT 1, 47 MILLBRAE ROAD**  
LANGSIDE

[www.corumproperty.co.uk](http://www.corumproperty.co.uk)





2 | BEDROOMS  
1 | BATHROOM  
1 | PUBLIC ROOM

A beautifully presented and generously proportioned first floor conversion, close to Queens Park and within the thriving Langside / Battlefield community.

- First floor conversion
- 2 double bedrooms
- Impressive bay window lounge
- Modern bathroom and kitchen
- Double glazing, gas central heating
- Great convenient location

Amenities

Located within the hub of Langside, the property is very well served by way of local shops and amenities all within walking distance. More extensive amenities are available at the Morrison's store at Crossmyloof/Newlands or indeed the Silverburn shopping mall at Pollok, a short drive to the West.

Recreational pursuits locally are in close proximity with Queens Park being approximately 250 yards away, providing nature walks, all weather football pitches and tennis courts.

Frequent public transport services provide rapid commuter access to the City Centre, the local railway stations at Langside or Mount Florida are both within one mile.

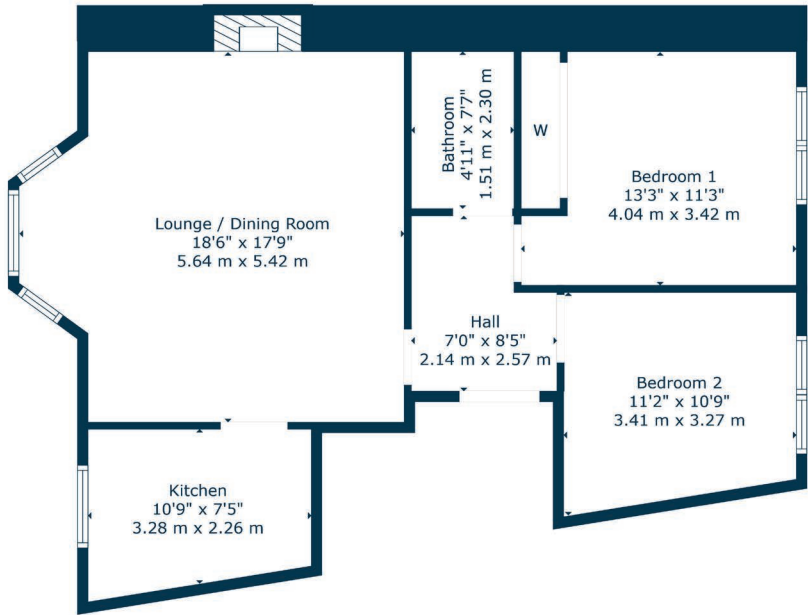

Sat Nav:  
Flat 1, 47 Millbrae Road, Langside, G42 9UF

SS5006

\*All measurements and distances are approximate.  
Floorplans are for illustration purposes and may not be to scale.

For the full home report visit  
[www.corumproperty.co.uk](http://www.corumproperty.co.uk)



WE'RE **SOLD** ON  
YOUR FUTURE



Corum Shawlands  
247 Kilmarnock Road, Shawlands, G41 3JF

Tel: 0141 636 7588

Email: [shawlands@corumproperty.co.uk](mailto:shawlands@corumproperty.co.uk)

[www.corumproperty.co.uk](http://www.corumproperty.co.uk)