



33 SECOND AVENUE

KINGS PARK

www.corumproperty.co.uk



c o r u m



3 | BEDROOMS

1 | BATHROOM

2 | PUBLIC ROOMS

A very well presented red sandstone fronted mid terrace villa, with driveway parking, landscaped gardens and modern specification.

Set within landscaped garden grounds in an admired pocket of the Southside, this sandstone fronted mid terrace home originally dates from the early 1900s and has been sympathetically upgraded and modernised by the current owners to now offer substantial and flexible accommodation. The accommodation extends to: private vestibule through twin doors, reception hallway and a lovely bay windowed lounge with feature fireplace and detailed ceiling plasterwork, a large dining room is positioned to the rear with access to a modern fitted kitchen and door to gardens. An original staircase with timber balustrade leads to first floor level revealing three versatile bedrooms, whilst a modern four piece bathroom suite is accessed from half landing. The attic space has been floored and lined, providing excellent additional storage, accessed by a ladder.

The specification retains period features such as fire surrounds, ceiling plasterwork and woodwork combined with gas central heating and double glazing. The rear garden is of particular note, fully enclosed and well stocked with a patio area next to the kitchen which is ideal for outside dining. The front garden has a paved driveway and provides off street parking.



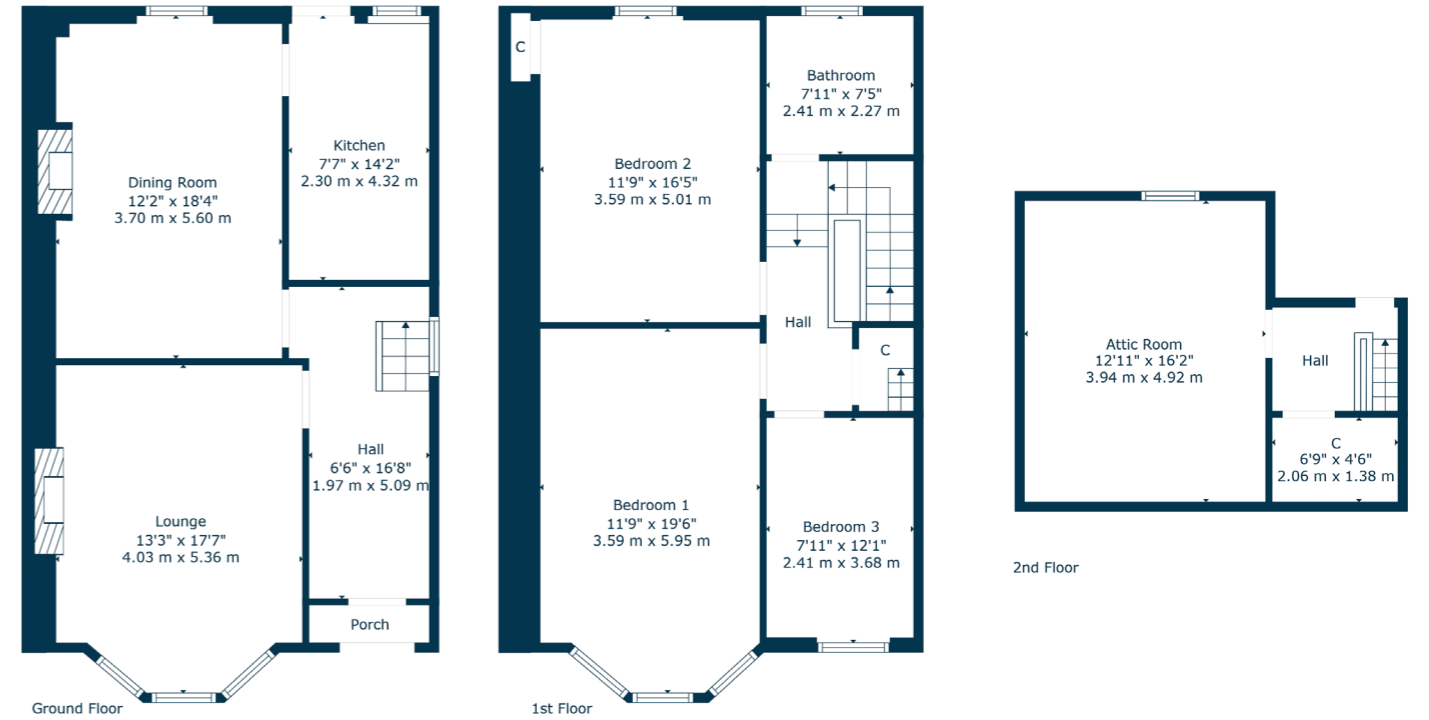

Second Avenue is within walking distance of shops upon Cathcart Road, Battlefield Road and Clarkston Road. More extensive amenities are available at the Sainsburys store in Muirend, the Asda store in Toryglen or Silverburn shopping centre a short drive to the West. Queens Park, Linn Park and Kings Park are within 1 mile of the property. The local railway stations are Mount Florida, Kings Park and Cathcart.

SS4889 | Sat Nav: 33 Second Avenue, Kings Park, G44 4TD

For the full home report visit www.corumproperty.co.uk

* All measurements and distances are approximate Floorplans are for illustration purposes and may not be to scale.



WE'RE **SOLD** ON
YOUR FUTURE



Corum Shawlands
247 Kilmarnock Road, Shawlands, G41 3JF

Tel: 0141 636 7588

Email: shawlands@corumproperty.co.uk

www.corumproperty.co.uk