



1/1, 597 SHIELDS ROAD

POLLOKSHIELDS

www.corumproperty.co.uk



2 | BEDROOMS
1 | BATHROOM
1 | PUBLIC ROOM

An outstanding first floor conversion of a sandstone townhouse, with a modern specification and period features.

- First floor conversion
- 2 bedrooms
- Tremendous drawing room
- Dining sized kitchen
- Modern bathroom
- Double glazed windows, gas central heating

Amenities

597 Shields Road is within half a mile of the retail thoroughfare on Nithsdale Road/ Kildrostan Street and further afield into Strathbungo. More extensive amenities are available at the Morrisons Crossmyloof store or the Sainsburys store on Darnley Road. Maxwell Park, Pollok Park or Queens Park are all within one mile of the property whilst Pollokshields West train station is around 500 yards away and the last stop of the Cathcart Circle before Glasgow Central. There are various bus routes locally whilst the M77 and M8 connect Glasgow to Scotland’s motorway network.

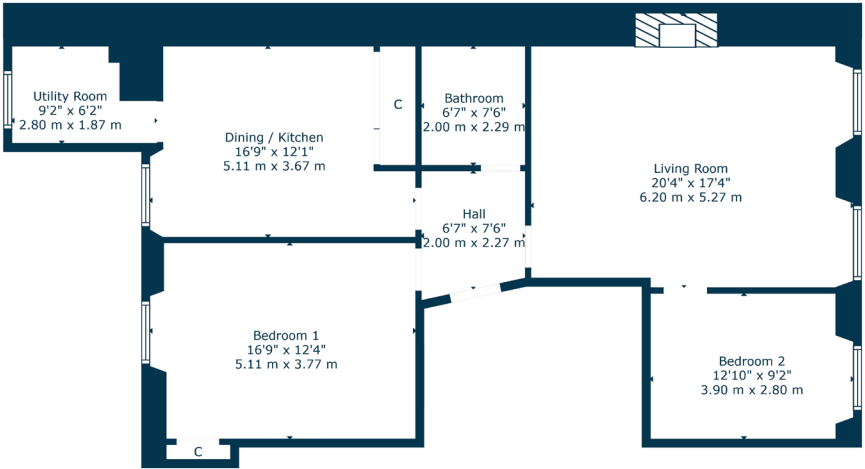

Sat Nav:
597 Shields Road, Pollokshields, G41 2RW

SS4872

*All measurements and distances are approximate.
Floorplans are for illustration purposes and may not be to scale.

For the full home report visit
www.corumproperty.co.uk



WE'RE **SOLD** ON
YOUR FUTURE



Corum Shawlands
247 Kilmarnock Road, Shawlands, G41 3JF

Tel: 0141 636 7588

Email: shawlands@corumproperty.co.uk

www.corumproperty.co.uk