



**0/1, 84 ALBERT AVENUE**

QUEENS PARK

[www.corumproperty.co.uk](http://www.corumproperty.co.uk)



**3 | BEDROOMS**  
**1 | BATHROOM**  
**1 | PUBLIC ROOM**

An exceptional traditional ground floor flat retaining beautiful features nearby Queens Park and bustling Strathbungo with own private front gardens.

- Ground floor flat with private garden
- 3 well laid out bedrooms
- Bay window lounge with fireplace
- Stunning dining sized kitchen
- Double glazing and gas central heating
- Period features retained

**Amenities**

Albert Avenue is positioned within walking distance of thriving amenities on Pollokshaws Road and Victoria Road, both providing a range of shops, coffee houses, restaurants, bars and delicatessens. More extensive facilities are available at the Morrisons supermarket at Crossmyloof or at the local Marks & Spencer and Sainsbury's stores.

Queens Park is less than 200 yards away allowing ideal recreational space with tennis courts, football pitches and nature walks. Public transport services (both bus and rail) provide fast commuter access to the City Centre and the local railway station is approximately 500 yards walk.

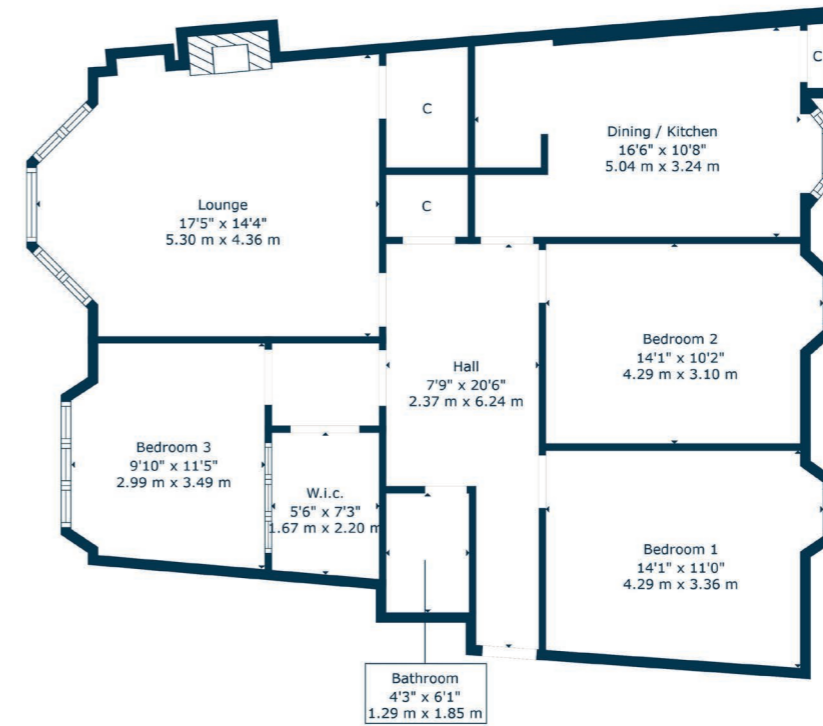

**Sat Nav:**  
 0/1, 84 Albert Avenue, Queens Park, G42 8RD

**SS4791**

\*All measurements and distances are approximate. Floorplans are for illustration purposes and may not be to scale.

For the full home report visit  
[www.corumproperty.co.uk](http://www.corumproperty.co.uk)



WE'RE **SOLD** ON  
YOUR FUTURE



Corum Shawlands  
247 Kilmarnock Road, Shawlands, G41 3JF

**Tel:** 0141 636 7588

**Email:** [shawlands@corumproperty.co.uk](mailto:shawlands@corumproperty.co.uk)

[www.corumproperty.co.uk](http://www.corumproperty.co.uk)