



**1/1, 20 LANGSIDE PLACE**

LANGSIDE

[www.corumproperty.co.uk](http://www.corumproperty.co.uk)



2 | BEDROOMS  
1 | BATHROOM  
2 | PUBLIC ROOMS

Occupying a prominent first floor position and presented to market in excellent order, this full two bedroom home sits in a maintained sandstone building. 20 Langside Place is in close proximity to popular retail haunts and the expansive greenspace of Queen's Park.

- Bay windowed lounge with wood burner
- Two generous double sized bedrooms
- Dining kitchen with walk-in pantry
- Contemporary 3 piece bathroom suite
- Gas central heating & double glazing
- 300 yards to the popular Queen's Park

Amenities

20 Langside Place is in close proximity to thriving shops, bars, coffee houses, bakeries and restaurants. A Morrisons, a Sainsburys, a Tesco and an M&S store are all within one mile of the property. The fringe of Queen's Park hosts a Farmers' Market on the 1st and 3rd Saturday of each month whilst recreational space, tennis courts and football pitches are readily available within the park. Shawlands Civic Square is also nearby, designed to offer a destination for markets, dance, craft events, speakers and debate.

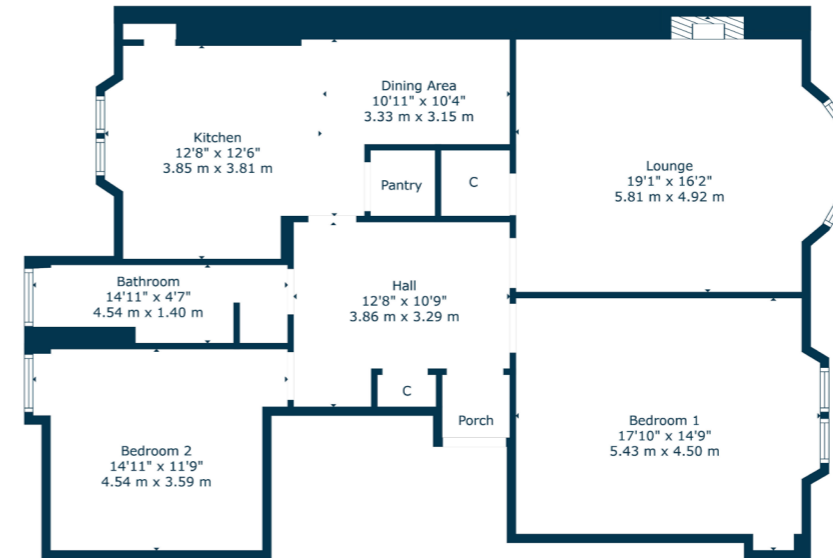

Sat Nav:  
1/1, 20 Langside Place, Langside, G41 3DL

SS4764

\*All measurements and distances are approximate. Floorplans are for illustration purposes and may not be to scale.

For the full home report visit  
[www.corumproperty.co.uk](http://www.corumproperty.co.uk)



WE'RE **SOLD** ON  
YOUR FUTURE



Corum Shawlands  
247 Kilmarnock Road, Shawlands, G41 3JF

**Tel:** 0141 636 7588

**Email:** [shawlands@corumproperty.co.uk](mailto:shawlands@corumproperty.co.uk)

[www.corumproperty.co.uk](http://www.corumproperty.co.uk)