



GARDEN CONVERSION

51 MARYWOOD SQUARE, STRATHBUNGO

www.corumproperty.co.uk



2 | BEDROOMS
1 | BATHROOM
1 | PUBLIC ROOM

A tremendous garden level floor conversion which sits in the flourishing Strathbungo district and is presented to market in beautiful condition.

- Impressive garden level conversion
- Large lounge to the front with bay window
- Two generous bedrooms
- Contemporary bathroom with separate shower enclosure
- Nicely landscaped resident's gardens to rear
- Recently upgraded and modernised

Amenities

51 Marywood Square is within walking distance of a diverse range of amenities including independent coffee shops, restaurants, bars and delicatessens. Strathbungo is nearby Queens Park delivering nature trails, football pitches and tennis courts. Pollokshields West and Queens Park train stations are within half a mile of the front door.

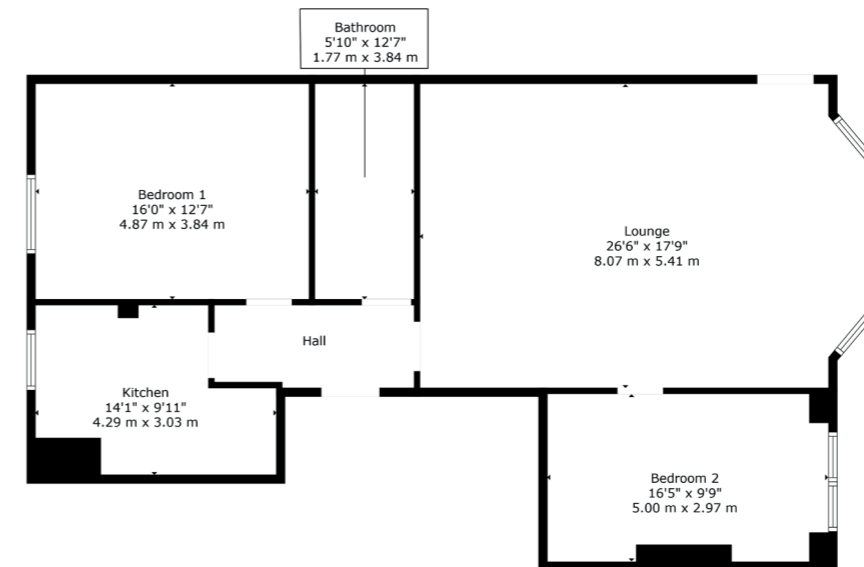

Sat Nav:
51 Marywood Square, Strathbungo, G41 2BN

SS4734

*All measurements and distances are approximate.
Floorplans are for illustration purposes and may not be to scale.

For the full home report visit
www.corumproperty.co.uk



WE'RE **SOLD** ON
YOUR FUTURE



C O R U M

Corum Shawlands
247 Kilmarnock Road, Shawlands, G41 3JF

Tel: 0141 636 7588

Email: shawlands@corumproperty.co.uk

www.corumproperty.co.uk