



**0/2, 309 CRAIGPARK DRIVE**

DENNISTOUN

[www.corumproperty.co.uk](http://www.corumproperty.co.uk)



2 | BEDROOMS  
1 | BATHROOM  
1 | PUBLIC ROOM

A fantastic two bedroom flat with internal kitchen, close to excellent amenities and transport links.

- Red sandstone building
- Elevated ground floor flat
- Private South facing front garden
- Two double bedrooms
- Bay windowed lounge giving access to kitchen
- Excellent transport links
- Double glazing

#### Amenities

309 Craigpark Drive is in the centre of Dennistoun where coffee houses, shops, restaurants and bars can be found. Local recreational pursuits are found nearby, alongside Alexandra Park in close proximity. Frequent public transport services (both bus and rail) provide rapid commuter access to the City Centre.

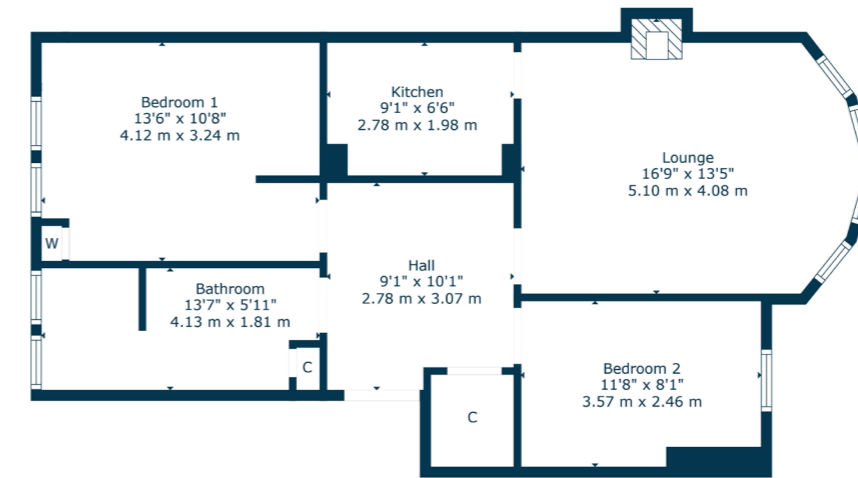

Sat Nav:  
0/2, 309 Craigpark Drive, Glasgow, G31 2TB

SS4680

\*All measurements and distances are approximate.  
Floorplans are for illustration purposes and may not be to scale.

For the full home report visit  
[www.corumproperty.co.uk](http://www.corumproperty.co.uk)



WE'RE **SOLD** ON  
YOUR FUTURE



Corum Shawlands  
247 Kilmarnock Road, Shawlands, G41 3JF

Tel: 0141 636 7588

Email: [shawlands@corumproperty.co.uk](mailto:shawlands@corumproperty.co.uk)

[www.corumproperty.co.uk](http://www.corumproperty.co.uk)