



Burley House



Burley House

Plymtree, Cullompton, EX15 2JX

Cullompton 4 miles; Honiton 8 miles; Exeter 13 miles

A well-maintained four-bedroom detached family home, set on a generous plot in a quiet village location, with private rear garden, driveway parking and double garage. EPC D

- Four bedrooms
- Beautiful private gardens
- Views over the church tower
- Freehold
- Village Pub
- Ample Parking
- Uffculme School secondary catchment
- Council Tax Band G

Guide Price £750,000

SITUATION

Tucked away in the heart of Plymtree, Burley House enjoys a peaceful village setting with a primary school, pub, church, and shop. Nearby Honiton offers rail links to London and access to the A30, while the M5 is reached via Cullompton, which also has a secondary school. Blundell's and Wellington private schools are within easy reach. Exeter provides extensive shopping, schooling, and leisure amenities, rail connections to London Paddington and Waterloo, and an international airport. Tiverton Parkway, 12 miles away, also serves the Paddington line.

DESCRIPTION

The front door opens to a central hallway with an under-stairs cupboard and a cloakroom with W.C. and wash basin. The bright, triple-aspect sitting room features an open fireplace and garden access, connecting via double doors to a dining room with a bay window. There's also a spacious study. The beautifully upgraded kitchen/breakfast room includes handle-less white units, quartz worktops, integrated appliances, and a central island with breakfast bar, plus patio doors to the garden. A utility room with matching units, sink, and laundry plumbing leads to the garage and garden.

Upstairs, the galleried landing leads to four bedrooms and a family bathroom. The main bedroom has two built-in wardrobes and an en suite with underfloor heating. All bedrooms have built-in storage, and the family bathroom includes a bath, separate shower, and underfloor heating. A large airing cupboard and boarded loft with ladder access complete the upper floor.

OUTSIDE

The property is approached via a private driveway providing ample parking and access to the integral double garage. The front garden is neatly landscaped, while the rear garden is of a generous size, including 2 sheds, 2 outside taps and is beautifully maintained, which also enjoys a high degree of privacy, an ideal space for relaxing or entertaining outdoors.

SERVICES

Mains water and electric. Septic tank drainage. Oil fired central heating. Standard and superfast broadband available. Mobile signal likely outside with all major networks. (Ofcom, 2025)

What3Words: ///numeral.sneezed.crusher





IMPORTANT: Stags gives notice that: 1. These particulars are a general guide to the description of the property and are not to be relied upon for any purpose. 2. These particulars do not constitute part of an offer or contract. 3. We have not carried out a structural survey and the services, appliances and fittings have not been tested or assessed. Purchasers must satisfy themselves. 4. All photographs, measurements, floorplans and distances referred to are given as a guide only. 5. It should not be assumed that the property has all necessary planning, building regulation or other consents. 6. Whilst we have tried to describe the property as accurately as possible, if there is anything you have particular concerns over or sensitivities to, or would like further information about, please ask prior to arranging a viewing.

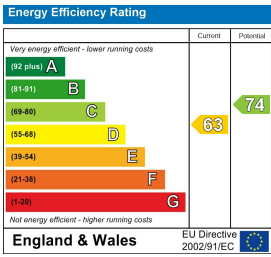

Bank House, 66 High Street,
Honiton, Devon, EX14 1PS

honiton@stags.co.uk
01404 45885

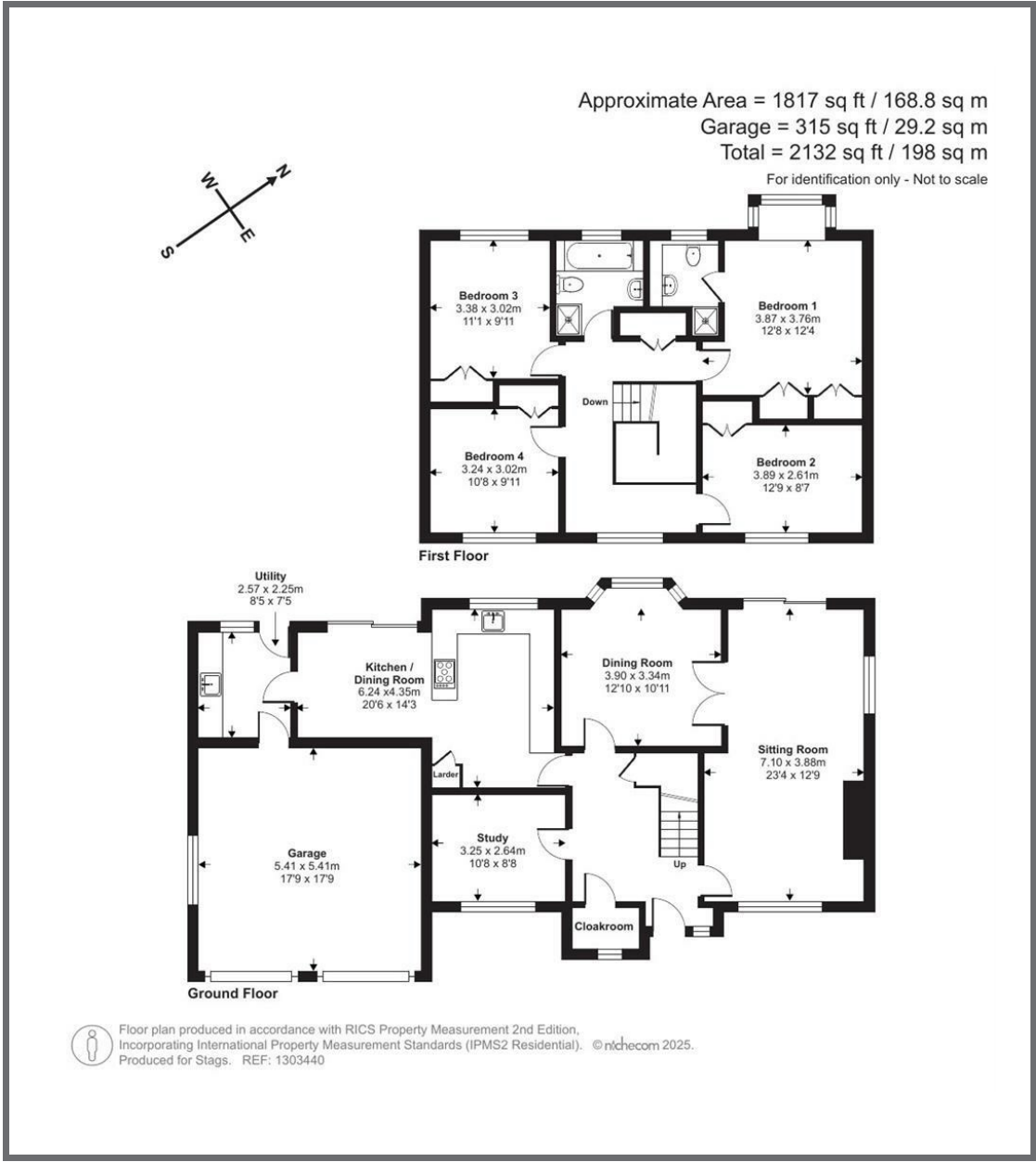

@StagsProperty

Cornwall | Devon | Somerset | Dorset | London