



0/2 2 NORTHLAND AVENUE
SCOTSTOUN

www.corumproperty.co.uk





2 | BEDROOMS

1 | BATHROOM

1 | PUBLIC ROOM

0/2 2 Northland Avenue is a superb, ground floor flat in the highly sought after Scotstoun district, close to a wealth of local amenities and transport links, and is located in the List One catchment area for Jordanhill School.

Internally, the accommodation comprises; welcoming reception hallway with ample storage off and access off to all apartments. There is a good-sized lounge to the front, offering open aspects over the well-maintained communal gardens, kitchen to the rear boasting a range of base and wall mounted units, and two well-proportioned double bedrooms, with principal bedroom further benefiting from built-in storage. A well-appointed main bathroom with three-piece suite completes the internal accommodation on offer.

The property features a secure entry system, gas central heating and double-glazed windows throughout. It also includes an allocated parking space and access to well-maintained communal grounds.



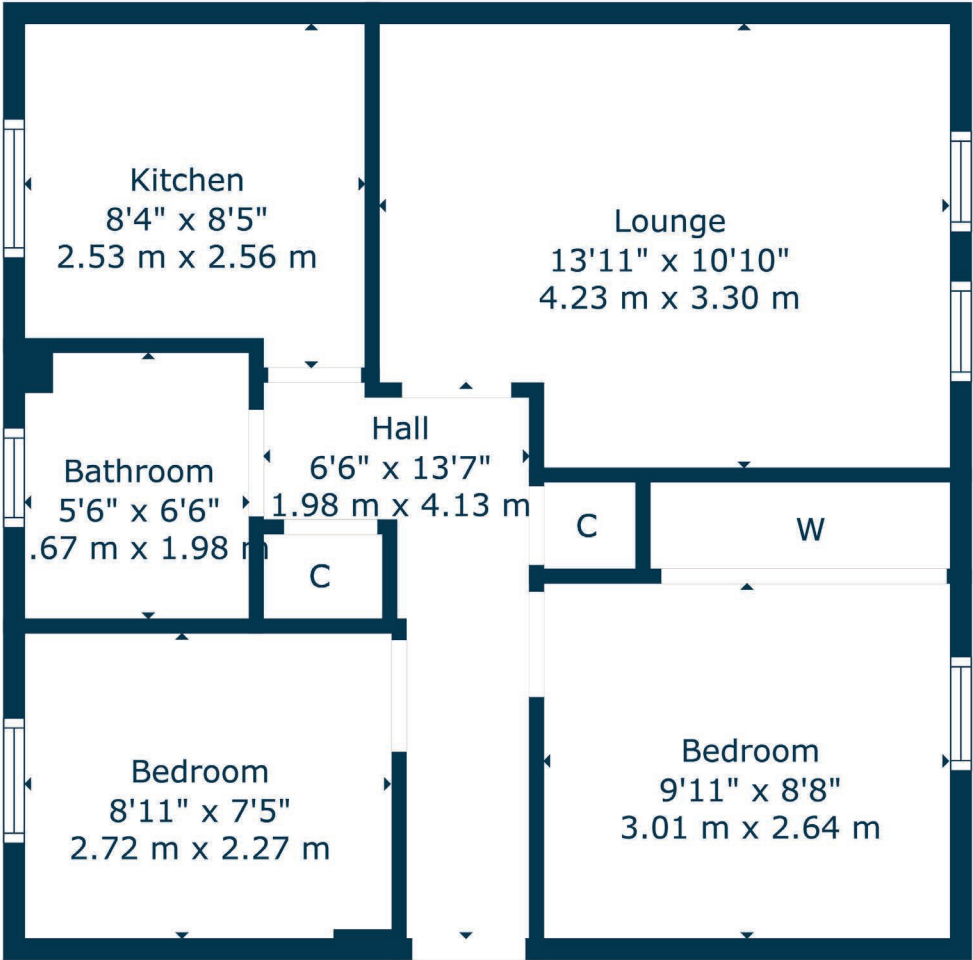

The Scotstoun Conservation Area offers superb local amenities, including nursery, pre-school, primary and secondary education, both within the private and state sectors. The renowned Scotstoun Leisure Centre, home to Glasgow Warriors, offers a wide range of sporting facilities and Victoria Park is also close at hand.

There are a wide range of shops catering for day-to-day needs within the area, along with a choice of restaurants and coffee houses. For commuters, there is a choice of railway stations and regular bus links on the main road arteries providing excellent commuting to the City Centre via the Clydeside Expressway and to the south of the city via the Clyde Tunnel.

WE5338 | Sat Nav: 0/2 2 Northland Avenue, Scotstoun, Glasgow, G14 9BN

For the full home report visit www.corumproperty.co.uk

* All measurements and distances are approximate Floorplans are for illustration purposes and may not be to scale.



WE'RE **SOLD** ON
YOUR FUTURE



Corum West End
82 Hyndland Road, Glasgow, G12 9UT

Tel: 0141 357 1888

Email: westendenq@corumproperty.co.uk

www.corumproperty.co.uk