



## 3.2 16 MANSFIELD STREET PARTICK

[www.corumproperty.co.uk](http://www.corumproperty.co.uk)







**2 | BEDROOMS**

**1 | BATHROOM**

**1 | PUBLIC ROOM**

**This superb, top floor, two-bedroom tenement flat is situated in the ever-popular Partick district of Glasgow's West End. An enviable spot allowing you to take in the best of both Hyndland and Partick and offers uninterrupted views over Mansfield Park. There are some fantastic local coffee shops, restaurants, and bars.**

The beautiful blonde sandstone tenement is accessed via a secure entry system, leading to a very well-maintained residents hall with stairwell leading to all levels. There is also access to a very well-presented communal rear courtyard.

The flat accommodation comprises; welcoming reception hall with storage off, a bright lounge to the front with feature fireplace, walk-in closet and wonderful leafy aspects over Mansfield Park, beautifully upgraded dining sized kitchen to the rear boasting a range of base and wall mounted units, space for dining and integrated appliances. There are two excellent double bedrooms to the rear, one of which boasts an expansive walk-in wardrobe and a stylish family bathroom with three-piece suite.

In addition, the property has gas central heating and residents on street permit parking are available via Glasgow City Council.







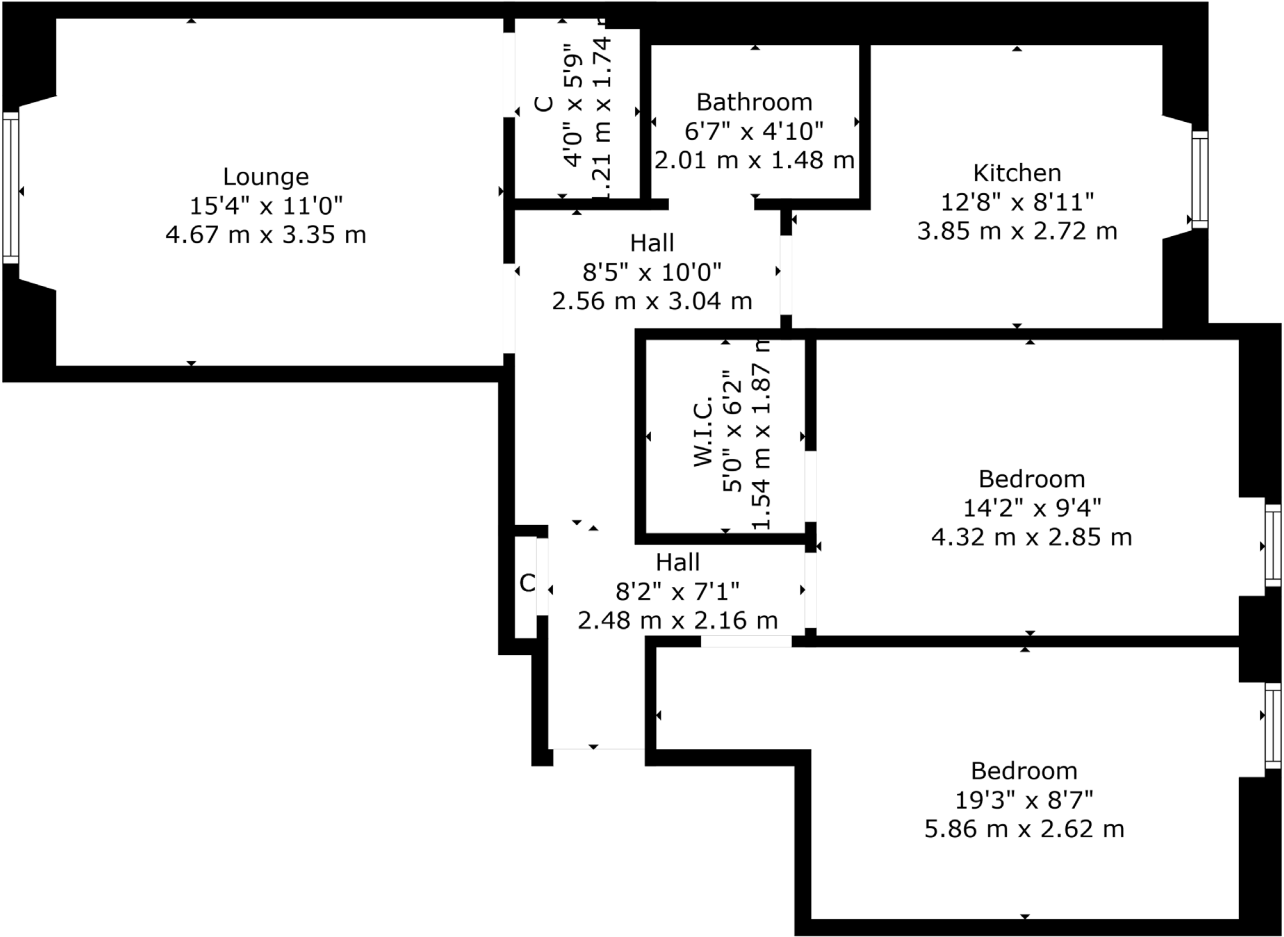

Partick in Glasgow's West End is fast becoming one of the 'hippest' neighbourhoods in which to live, as quoted by The Scotsman in 2018. An ideal location for first time buyers and young professionals.

Partick is a bustling, evolving community near the University of Glasgow and has become a hugely desirable and attractive location providing a variety of trendy wine bars, popular restaurants and gourmet coffee shops such as Celino's, Bibi's, Ziques, Gaga and The Partick Duck Club.

Glasgow's maritime history is explored at the Riverside Museum and Tall Ship, and Victoria Park features fossilised tree stumps and former gardens. Partick was once a district well known for its shipyards and grain mills which played a crucial role in Scotland's Industrial revolution.

**WE5308** | Sat Nav: 16 Mansfield Street, Partick, G11 5QP

For the full home report visit [www.corumproperty.co.uk](http://www.corumproperty.co.uk)

\* All measurements and distances are approximate Floorplans are for illustration purposes and may not be to scale.





WE'RE **SOLD** ON  
YOUR FUTURE



Corum West End  
82 Hyndland Road, Glasgow, G12 9UT

**Tel:** 0141 357 1888

**Email:** [westendnq@corumproperty.co.uk](mailto:westendnq@corumproperty.co.uk)

[www.corumproperty.co.uk](http://www.corumproperty.co.uk)