



33C BRAID SQUARE
WOODSIDE

www.corumproperty.co.uk





3 | BEDROOMS

1 | BATHROOM

1 | PUBLIC ROOM

33C Braid Square is a fantastic, extensively refurbished, three bedroom maisonette apartment, situated in the highly sought after North Woodside district, and is perfectly located for a wealth of local amenities and transport links including close access to the M8 and City Centre.

The building is entered via main door access leading to a welcoming reception hall with large storage cupboard off and provides access to all lower apartments. There is a bright and spacious lounge to the rear with direct access to the newly slabbed patio area with open outlook over Braid Park, which has received planning consent to fully landscape the area. More information can be found at 'Woodside Making Places'. There is a fully modernised kitchen with a selection of base and wall mounted units and integrated appliances, spacious dining room/third bedroom to the front and W.C. off the hall. Stairs lead to the upper level with storage off the landing, two generous double bedrooms with the principle boasting ample in-built storage space and finally, a recently upgraded modern three piece shower room.

The property has electric heating and is double glazed. On street permit parking is available on request via Glasgow City Council.



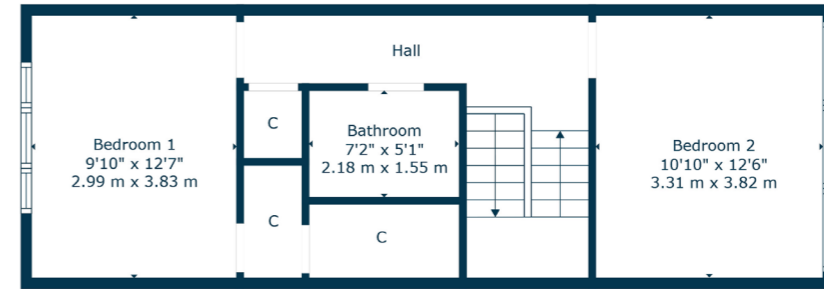

Floor 2

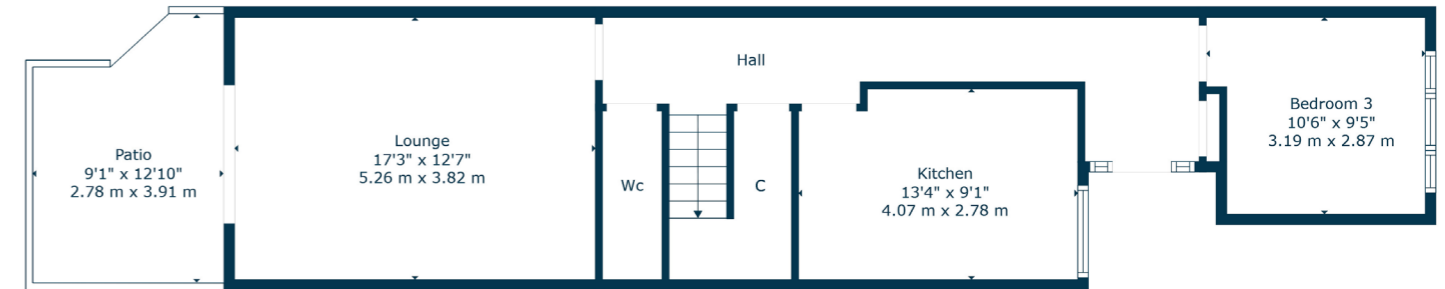

Floor 1



Woodside is well situated for access to the vibrant West End, including the University of Glasgow, Kelvingrove Park and the Botanic Gardens. St George's Cross Underground Station is located close by, with several bus services linking to the City Centre and beyond.

There are a host of amenities nearby, including an excellent selection of well-established coffee shops, restaurants and bars nearby Great Western Road including Paesano Pizza, Cottonrake Bakery, Roots Fruits & Flowers, La Lanterna and Farrow & Ball.

There are also a number of excellent local primary and secondary schools nearby as well as Woodside Leisure Centre, which is directly across from the property.

WE5022 | Sat Nav: 33 Braid Square, Woodside, G4 9YQ

For the full home report visit www.corumproperty.co.uk

* All measurements and distances are approximate Floorplans are for illustration purposes and may not be to scale.



WE'RE **SOLD** ON
YOUR FUTURE



Corum West End
82 Hyndland Road, Glasgow, G12 9UT

Tel: 0141 357 1888

Email: westendnq@corumproperty.co.uk

www.corumproperty.co.uk