



5A GREAT WESTERN TERRACE

HYNDLAND

www.corumproperty.co.uk





2 | BEDROOMS

1 | BATHROOM

1 | PUBLIC ROOM

Situated on one of the most sought-after terraces in Glasgow's West End with a stunning, shared south west facing rear garden, is the garden flat at 5A Great Western Terrace which is without a doubt one of the most appealing properties of its kind on the market.

This A-Listed property was designed by Alexander "Greek" Thomson circa 1869 and is in immaculate order through-out. The apartment has a shared and very well-maintained communal hall with one other garden flat. The accommodation comprises: large welcoming reception hall with ample storage off, beautiful open plan lounge kitchen and dining area which in turn, provides access to the superb shared South facing garden. There are two double bedrooms, the principal with excellent wardrobe space and a recently fitted, very stylish family shower room.

The property benefits from gas central heating, beautiful décor, hardwood and quality carpeting throughout. Residents permit parking can be obtained on request via Glasgow City council.



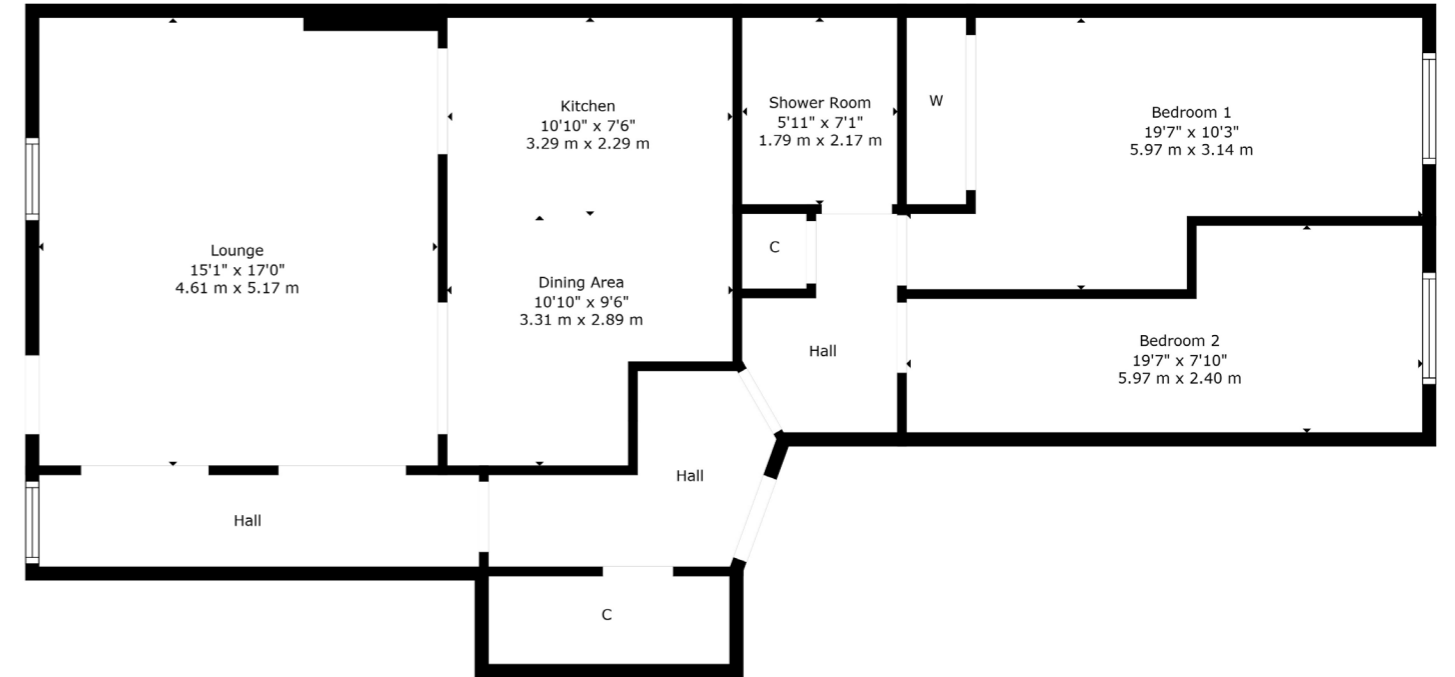

Hyndland is highly regarded as the social hub of the West End. The area has been truly transformed in the last ten years with a number of excellent bars and restaurants including, Epicures by Cail Bruich, Shucks, Jelly Hill, Caffé Parma, Peckhams and Cottiers. There is also a variety of independent shops and boutiques, including Bluebellgray, Silks, Brenda Muir, Pampas, Biscuit Clothing, Good Story and independent retail stores such as Bauen Design, offering stunning bespoke kitchens, and Chelsea McLaine Interior Designers.

WE4978 | Sat Nav: 5 Great Western Terrace, Hyndland, G12 0UP

For the full home report visit www.corumproperty.co.uk

* All measurements and distances are approximate Floorplans are for illustration purposes and may not be to scale.



WE'RE **SOLD** ON
YOUR FUTURE



Corum West End
82 Hyndland Road, Glasgow, G12 9UT

Tel: 0141 357 1888

Email: westendenq@corumproperty.co.uk

www.corumproperty.co.uk