



The Water Gardens  
Hyde Park, W2









A beautifully refurbished two-bedroom apartment situated within an exclusive gated development in the prestigious Hyde Park area. This modern residence offers well-appointed accommodation comprising two generously proportioned double bedrooms, a sleek contemporary bathroom, a fully fitted kitchen, and a spacious, light-filled reception room ideal for both relaxing and entertaining.

Perfectly positioned, the property benefits from close proximity to an array of local amenities and exceptional transport connections, with Hyde Park, Marylebone, Marble Arch, Lancaster Gate, and Paddington all within easy reach.

- Newly refurbished
- Two bedrooms and one bathroom
- Wooden floor throughout
- 24 hour concierge
- Communal gardens

### £3,200 pcm

Additional tenant charges apply (fees apply to non-AST tenancies only)

Tenancy Agreement Fee: £300

References per Tenant/Guarantor: £60

Inventory check (approx. £100 – £250 inc. VAT)

[chestertons.co.uk/property-to-rent/applicable-fees](https://chestertons.co.uk/property-to-rent/applicable-fees)

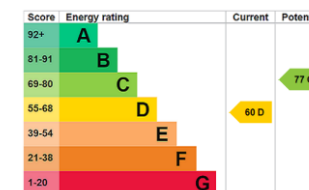

**Minimum Term:** 12 months  
**Deposit Required:** Five weeks  
**Local Authority:** Westminster  
**Council Tax Band:** F  
**EPC Rating:** D  
**Furnished**

### Chestertons Hyde Park & Marylebone Lettings

40 Connaught Street  
 Hyde Park & Marylebone  
 London  
 W2 2AB

[hydeparklettingsusers@chestertons.co.uk](mailto:hydeparklettingsusers@chestertons.co.uk)  
 02072985950

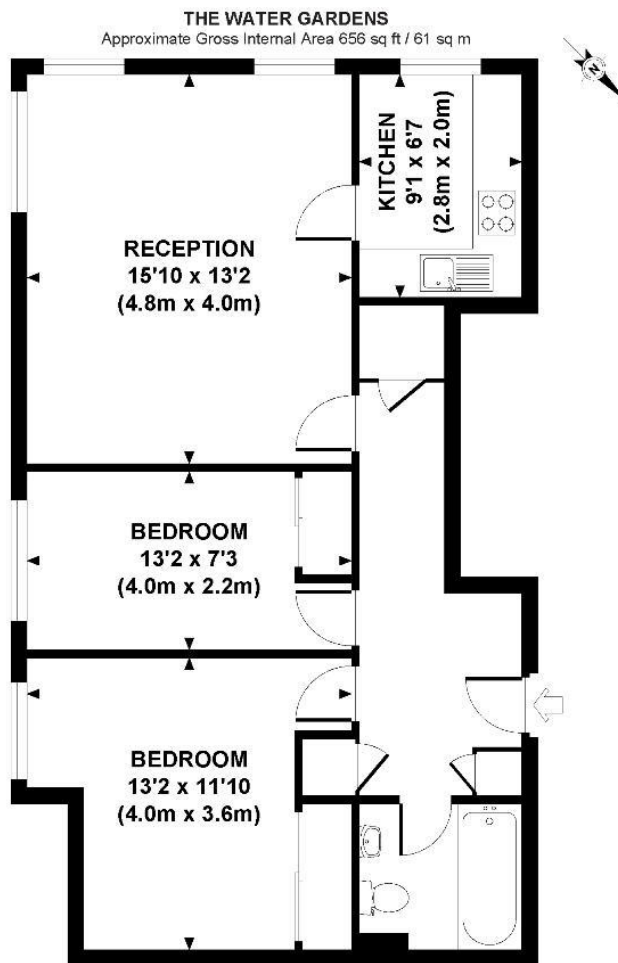

**GROUND FLOOR  
GROSS INTERNAL  
FLOOR AREA 656 SQ FT**

Although every attempt has been made to ensure accuracy, all measurements are approximate.  
The floor plan/s for illustrative purposes only and not to scale. Measured in accordance to RICS standards.  
DE-PHOTOGRAPHY.NET

Chesterton UK Services Limited trading as Chestertons for themselves and for the vendor of this property whose agents they are, give notice that (i) these particulars do not constitute any part of an offer or contract, (ii) all statements contained within these particulars are made without responsibility on the part of Chestertons or the vendor, (iii) whilst made in good faith, none of the statements contained within these particulars are to be relied upon as a statement or representation of fact, (iv) any intending purchasers must satisfy themselves by inspection or otherwise as to the correctness of each of the statements contained within these particulars, (v) the vendor does not make or give either Chestertons or any person in their employment any authority to make or give representation or warranty whatsoever in relation to this property. Wide angle lenses may be used. ©Copyright Chestertons | Chesterton Global Ltd | Registered Office 40 Connaught Street, Hyde Park, London W2 2AB Registered Company Number 05334580.