



Burwood Place  
London, W2

CHESTERTONS







A two bedroom apartment within a popular, portered block in Hyde Park.

The accommodation comprises a master bedroom with fitted wardrobe and en-suite shower room, a further double bedroom, a fully integrated kitchen, an additional family bathroom, and bright reception room. The Property further benefits from a porter and lift.

Rent inclusive of weekly cleaning.

The property is ideally situated to local amenities, excellent transport links via Marble Arch and Paddington Stations.

- Two bedrooms
- Two bathrooms
- Porter
- Lift
- First floor
- Inclusive of hot water and heating

**£3,000 pcm**

Additional tenant charges apply (fees apply to non-AST tenancies only)

Tenancy Agreement Fee: £300

References per Tenant/Guarantor: £60

Inventory check (approx. £100 – £250 inc. VAT)

[chestertons.co.uk/property-to-rent/applicable-fees](http://chestertons.co.uk/property-to-rent/applicable-fees)

Energy Efficiency Rating		Current	Potential
100-109	A		
81-100	B		
62-81	C	74	74
43-61	D		
25-42	E		
10-24	F		
1-9	G		

Not energy efficient - higher running costs

England, Scotland & Wales EU Directive 2002/91/EC

**Minimum Term:** 12 months  
**Deposit Required:** Five weeks  
**Local Authority:** City Of Westminster  
**Council Tax Band:** G  
**EPC Rating:** C  
**Furnished**

*Chestertons Hyde Park & Marylebone Lettings*

40 Connaught Street  
 Hyde Park & Marylebone  
 London  
 W2 2AB

hydepark@chestertons.co.uk

02072985950

## Burwood Place, W2

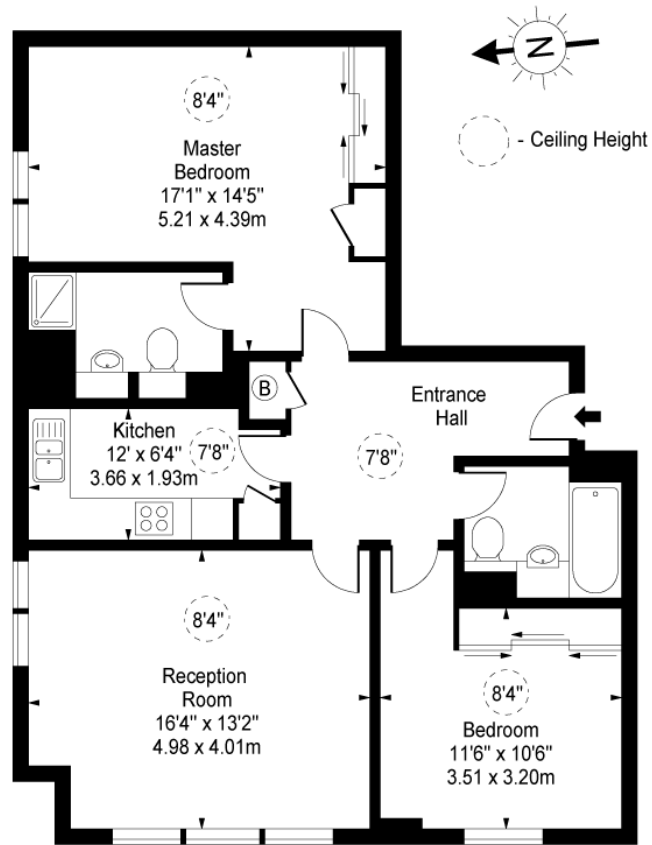

First Floor

Approx Gross Internal Area **864 Sq Ft - 80.26 Sq M**

For Illustration Purposes Only - Not To Scale  
[www.goldlens.co.uk](http://www.goldlens.co.uk)  
Ref. No. 012421E

Chesterton Global Ltd trading as Chestertons for themselves and for the vendor of this property whose agents they are, give notice that (i) these particulars do not constitute any part of an offer or contract, (ii) all statements contained within these particulars are made without responsibility on the part of Chestertons or the vendor, (iii) whilst made in good faith, none of the statements contained within these particulars are to be relied upon as a statement or representation of fact, (iv) any intending purchasers must satisfy themselves by inspection or otherwise as to the correctness of each of the statements contained within these particulars, (v) the vendor does not make or give either Chestertons or any person in their employment any authority to make or give representation or warranty whatsoever in relation to this property. Wide angle lenses may be used. ©Copyright Chestertons | Chesterton Global Ltd | Registered Office 40 Connaught Street, Hyde Park, London W2 2AB Registered Company Number 05334580.



This paper is  
100% recyclable