



# Clarewood Court

Seymour Place, W1H

£595 per week  
(£2,578.33 pcm)

A modern two bedroom apartment on the first floor of a mansion block in Marylebone. Recently refurbished to a high standard this property benefits from an open plan reception room, wooden flooring and a lift.

**CHESTERTONS**

**Clarewood Court,  
Seymour Place, W1H**

○ - Ceiling Height

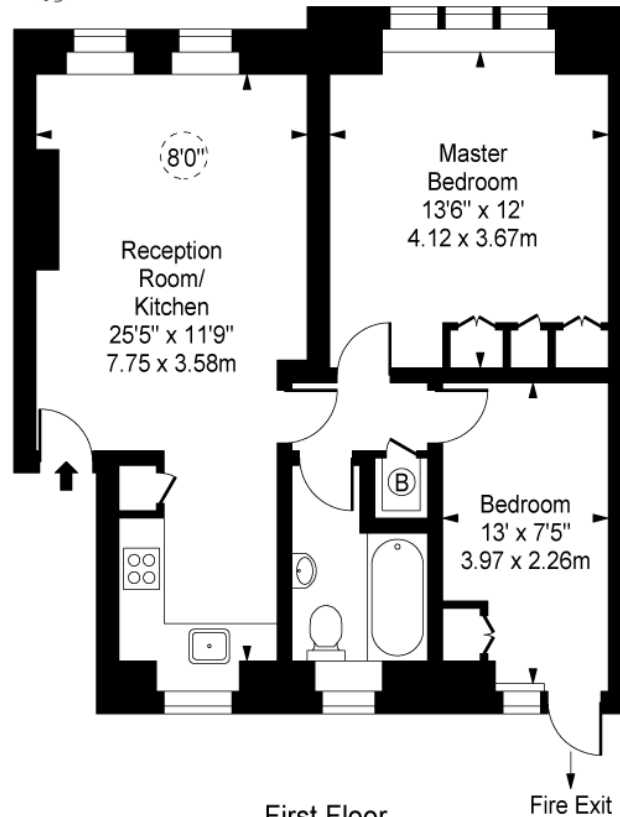

First Floor

Fire Exit

Approx Gross Internal Area **622 Sq Ft - 57.78 Sq M**

For Illustration Purposes Only - Not To Scale  
www.goldlens.co.uk  
Ref. No. 015222AG

**Tenure:** Long Let, Minimum term 6 months

**Furnished**

Additional tenant charges apply (fees apply to non-AST tenancies only)

Tenancy Agreement Fee: £300

References per Tenant/Guarantor: £60

Inventory check (approx. £100 – £250 inc. VAT)

[chestertons.com/property-to-rent/applicable-fees](http://chestertons.com/property-to-rent/applicable-fees)

Energy Efficiency Rating		
	Current	Potential
Very energy efficient - lower running costs		
(92+) <b>A</b>		
(81-91) <b>B</b>		
(69-80) <b>C</b>		
(55-68) <b>D</b>		
(39-54) <b>E</b>		
(21-38) <b>F</b>		
(1-20) <b>G</b>		
Not energy efficient - higher running costs		
England, Scotland & Wales		
EU Directive 2002/91/EC		

**Chestertons Hyde Park & Marylebone Lettings**

40 Connaught Street

Hyde Park & Marylebone

London

W2 2AB

[lettings.hydepark@chestertons.com](mailto:lettings.hydepark@chestertons.com)

02072985950

Chesterton Global Ltd trading as Chestertons for themselves and for the vendor of this property whose agents they are, give notice that (i) these particulars do not constitute any part of an offer or contract, (ii) all statements contained within these particulars are made without responsibility on the part of Chestertons or the vendor, (iii) whilst made in good faith, none of the statements contained within these particulars are to be relied upon as a statement or representation of fact, (iv) any intending purchasers must satisfy themselves by inspection or otherwise as to the correctness of each of the statements contained within these particulars, (v) the vendor does not make or give either Chestertons or any person in their employment any authority to make or give representation or warranty whatsoever in relation to this property. Wide angle lenses may be used. ©Copyright Chestertons | Chesterton Global Ltd | Registered Office 40 Connaught Street, Hyde Park, London W2 2AB Registered Company Number 05334580.



This paper is  
100% recyclable