

Stanhope Terrace

London, W2

£5,200 per month
(£1,200 per week)

In the vibrant heart of the West End. Nestled on Stanhope Terrace, a distinguished residential avenue, it enjoys proximity to the lush expanses of the parkland and an array of upscale boutiques, charming cafes, and gourmet dining options.



Stanhope Terrace

London, W2

- Own Private Entrance
- Grand Period Conversion
- One Large Double Bedroom
- Direct Access to Hyde Park Gardens
- High Ceilings
- Stunning Cornicing
- Wooden Flooring Throughout



Presenting immaculate interiors, a shared garden retreat, and exclusive parking privileges, this exquisite 1-bedroom residence commands a coveted position mere steps from the iconic Hyde Park in the vibrant heart of the West End. Nestled on Stanhope Terrace, a distinguished residential avenue, it enjoys proximity to the lush expanses of the parkland and an array of upscale boutiques, charming cafes, and gourmet dining options.

Minimum Term: 1 months
Deposit Required: £2,400.00
Local Authority: City Of Westminster
Council Tax Band: E
EPC Rating: D
Furnished

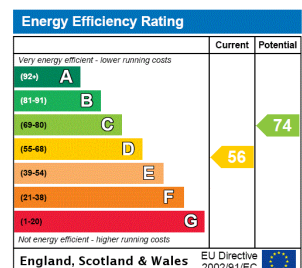

Chestertons Hyde Park & Marylebone Lettings

40 Connaught Street
 Hyde Park & Marylebone
 London
 W2 2AB
 hydepark@chestertons.co.uk
 02072985950
 chestertons.co.uk

Additional tenant charges apply (fees apply to non-AST tenancies only)
 Tenancy Agreement Fee: £300
 References per Tenant/Guarantor: £60
 Inventory check (approx. £100 – £250 inc. VAT)
 chestertons.co.uk/property-to-rent/applicable-fees

Stanhope Terrace, W2

○ - Ceiling Height

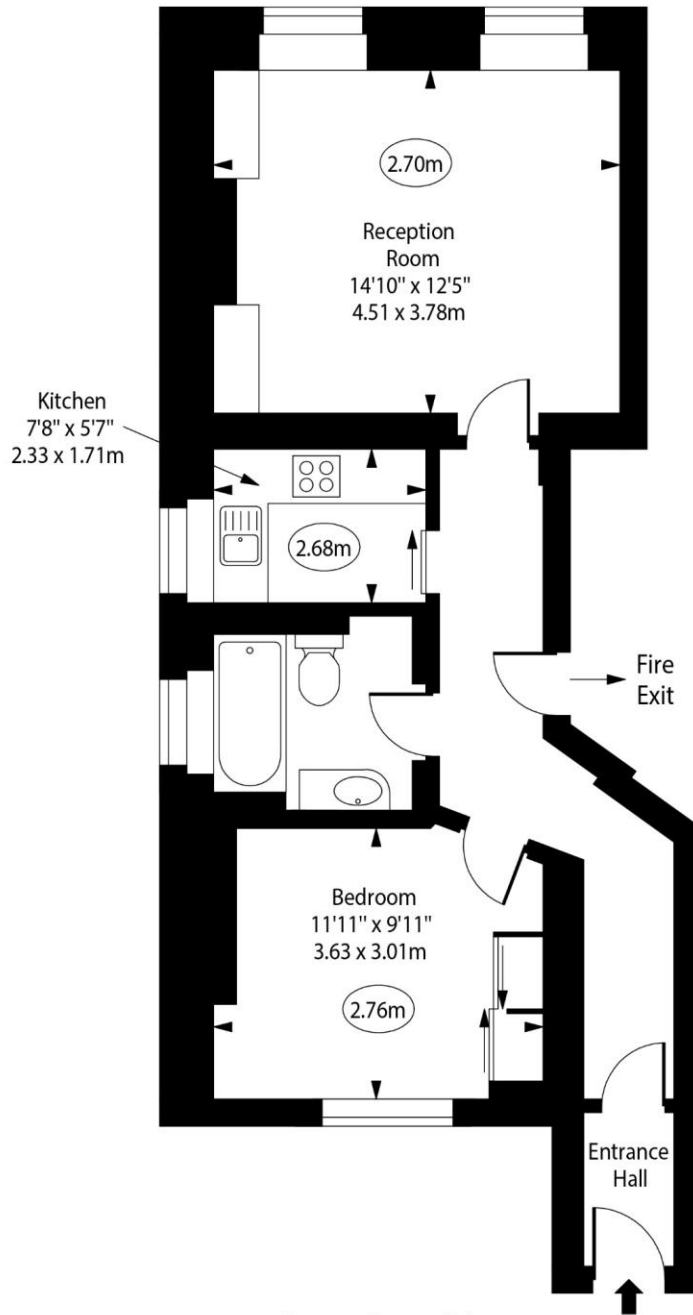

Lower Ground Floor

Approx Gross Internal Area 556 Sq Ft - 51.65 Sq M

For Illustration Purposes Only - Not To Scale

www.goldlens.co.uk

Ref. No. 021437R

