



# ANEMONE

Taking design inspiration from Nordic countries, the Anemone is an attractive, three-bedroom, two-storey property.

88 sq m (947 sq ft)

CHILMINGTON

# RISE

KENT

ASHFORD KENT TN23 3DN

**Connells**

[www.chilmington-rise.co.uk](http://www.chilmington-rise.co.uk)

# ANEMONE

Taking design inspiration from Nordic countries, the Anemone is an attractive, three-bedroom, two-storey property.

Allocation of garages, carports and off-road parking differs from plot to plot. For more information, please speak to the sales team.

**88 sq m (947 sq ft)**

The ground floor hallway leads to the kitchen and through to the living/dining to the rear of the house where double doors lead to the patio and garden.

On the first floor you'll find two bedrooms and a family bathroom in addition to the master bedroom with en-suite and built-in wardrobes.

## GROUND FLOOR

### Living / Dining Area

4.95m x 3.54m 16'3" x 11'7"

### Kitchen

4.05m x 2.67m 13'5" x 8'10"

## FIRST FLOOR

### Master Bedroom with en-suite

4.6m x 2.7m 15'1" x 8'10"

### Bedroom 2

2.76m x 2.7m 9'2" x 8'10"

### Bedroom 3

3.54m x 2.15m 11'6" x 7'1"



Ground Floor Plan Left

Ground Floor Plan Right

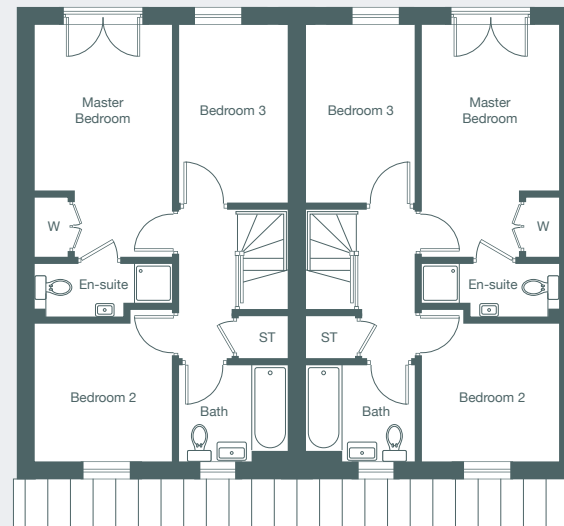

First Floor Plan Left

First Floor Plan Right

Each set of floor plans may be reproduced at a different scale to others within the brochure. Floor plans, dimensions and CGI illustrations are indicative only and can be liable to change during construction. Please check with the sales agent if you require further information.



### Sales Suite

Open Daily  
Monday to Sunday 10am-5pm

### Telephone

01233 622 206  
01233 502 020

### ANEMONE

Plots 51, 52, 64, 72, 101, 102, 230, 231, 232, 233.