



14 CHISHOLM DRIVE

NEWTON MEARNS

www.corumproperty.co.uk





3 | BEDROOMS

1 | BATHROOM

1/2 | PUBLIC ROOMS

One of the larger style semi detached villas that is set within great sized and fully enclosed mature garden grounds.

This traditional semi detached villa enjoys a quiet yet convenient location within this sought after pocket of Newton Mearns. The subjects are conveniently located for a full range of local amenities, facilities, and of course local excellent schooling.

The well proportioned accommodation in brief extends to on the ground floor, reception hallway, fantastic open plan lounge/dining room, and fitted kitchen with access to rear gardens. Upstairs landing gives access to generous principal bedroom, lovely second rear facing bedroom, third great sized bedroom and main family shower room. Further attic storage which has been floored and lined. The specification includes gas central heating and double glazing.

Set within level garden grounds with lawn area to front and rear with well stocked planting beds. Long driveway to the side offering parking for multiple vehicles leads to detached garage. Fully enclosed and gated rear garden with patio areas and large lawn area.

The floor plan shall provide you with a detailed layout of this fantastic family home, however, we recommend viewing to appreciate the size and convenient location on offer.



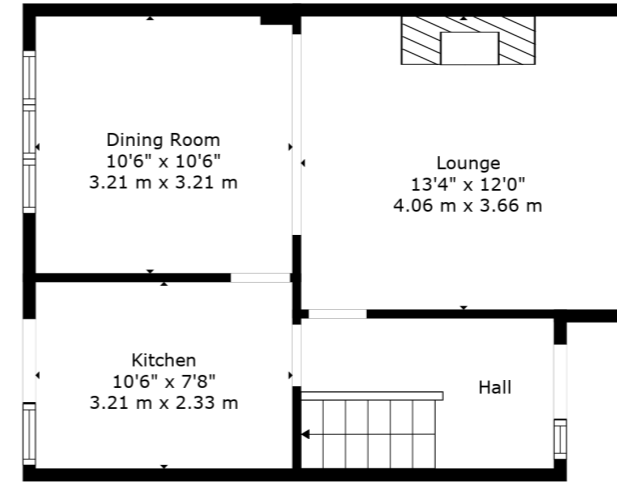

Ground Floor

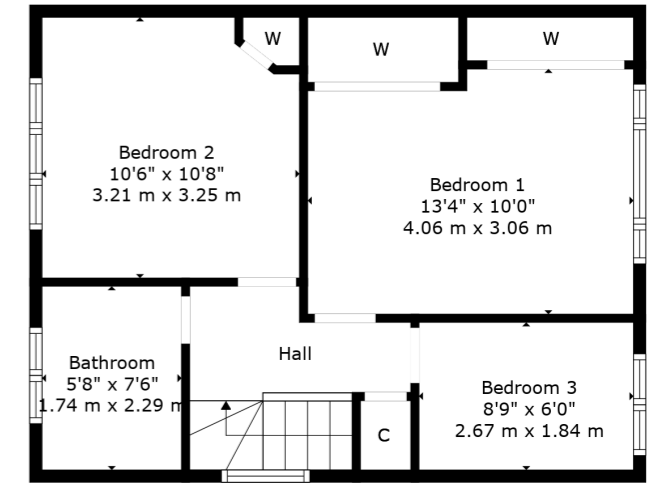

1st Floor

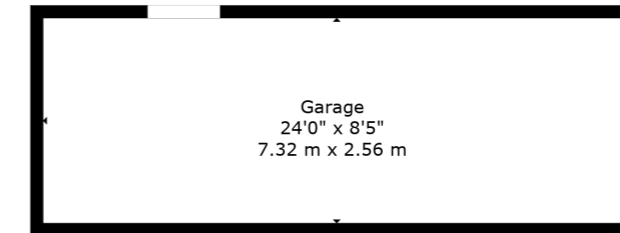

Situated within a highly sought after pocket of Newton Mearns, the property is superbly placed for a wide range of amenities and indeed nationally recognised schooling. A wide variety of restaurants, supermarkets and retailers can be found at the nearby Mearns Cross Shopping Centre and Greenlaw Village, and there are a range of sports and leisure activities found within the district including parks, health clubs, gyms, and golf courses. Excellent local transport links providing swift access to the city centre and beyond are also close at hand with Patterton Station being the nearest.

NM4437 | Sat Nav: 14 Chisholm Drive, Newton Mearns, G77 6HX

For the full home report visit www.corumproperty.co.uk

* All measurements and distances are approximate Floorplans are for illustration purposes and may not be to scale.



WE'RE **SOLD** ON
YOUR FUTURE



Corum Newton Mearns
134 Ayr Road, Newton Mearns, G77 6EG

Tel: 0141 639 5888

Email: n.mearns@corumproperty.co.uk

www.corumproperty.co.uk