



49 WOODLANDS PARK

THORNLIEBANK

www.corumproperty.co.uk



2 | BEDROOMS
1 | BATHROOM
1 | PUBLIC ROOM

This fantastic, terraced villa enjoys a quiet yet highly convenient location and set within level private gardens, backing on to mature woodlands.

- Modern terrace villa set within level private gardens.
- Two well proportioned bedrooms.
- Well presented and decorated throughout.
- Private gardens and residents parking.
- Gas central heating and double glazing.
- Excellent proximity to amenities and transport links.

Amenities

Thornliebank is a suburban village south of Glasgow with excellent transport links via bus and train close at hand, in addition to local motorway links (M77/M8) providing swift access to the city centre and Ayrshire. A haven for young growing families, the district is synonymous with some of the best schooling in the West of Scotland. There are two train stations within close proximity Thornliebank Train Station and Whitecraigs Train Station. There are numerous independent shops, restaurants and delicatessens. An abundance of sports and leisure facilities are a short distance away including David Lloyd Sports Club, Nuffield Health Gym, Whitecraigs Golf Club, Giffnock and Whitecraigs Tennis Clubs and Rouken Glen Park.

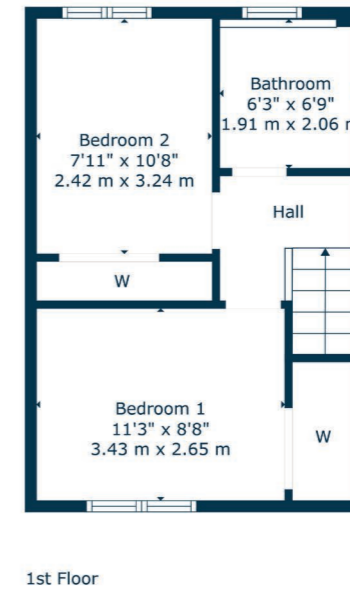
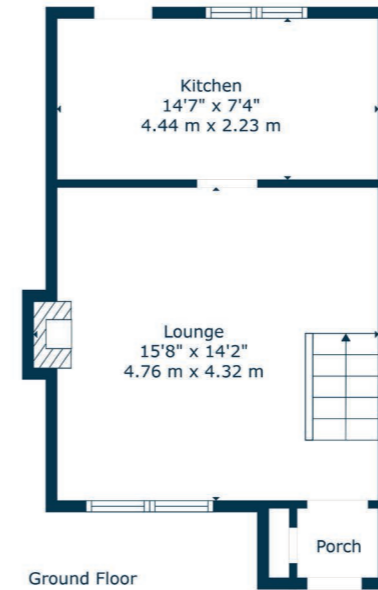

Sat Nav:
 49 Woodlands Park, Thornliebank G46 7RZ

NM4422

*All measurements and distances are approximate. Floorplans are for illustration purposes and may not be to scale.

For the full home report visit
www.corumproperty.co.uk



WE'RE **SOLD** ON
YOUR FUTURE



Corum Newton Mearns
134 Ayr Road, Newton Mearns, G77 6EG

Tel: 0141 639 5888

Email: n.mearns@corumproperty.co.uk

www.corumproperty.co.uk