



1 NETHERTON ROAD

NEWTON MEARNS

www.corumproperty.co.uk





5 | BEDROOMS

2 | BATHROOMS

3/4 | PUBLIC ROOMS

An impressive, detached period bungalow set within large garden grounds with double garage and outbuildings.

This is a 1930's detached period residence that delivers expansive, highly flexible family accommodation formed over a two-storey layout. The property delivers a significant amount of square footage, large room sizes and is particularly bright and airy with a lot of natural light and sense of space.

The property on the ground floor extends to large entrance vestibule, magnificent octagonal shaped reception hallway offering access to all accommodation, large bay windowed family room, large bay windowed lounge with focal point fireplace, principal bedroom with dressing area and en-suite bathroom, second downstairs double bedroom, refitted and modernised family bathroom, rear hallway offers extra cloaks storage area and leads through to a large dining/family area which is semi open plan to a kitchen and in turn gives access to utility/laundry area with further storage. Upper accommodation provides bright landing area with two double sized bedrooms, both with built in storage and a fifth nursery bedroom/home office. The upper accommodation is complete with a newly fitted WC. The property has a system of gas central heating with an Alpha fitted boiler approximately 18 months ago. Fully guaranteed. Mainly upgraded double glazed windows throughout.

Broad fronted, landscaped front garden grounds with a very large driveway leads to double garage, large outhouse/store and additional outbuildings providing further storage. Lawned rear garden grounds. Boiler house.



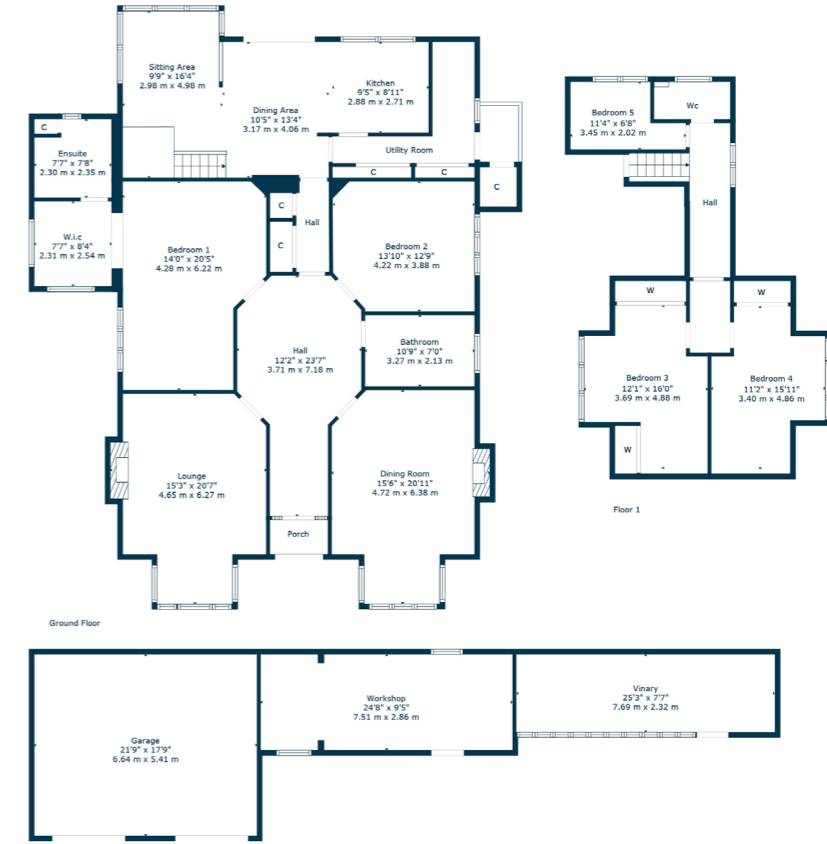

Newton Mearns is one of the most sought-after suburbs within the south side of Glasgow. The property is superbly placed for a wide range of amenities and indeed nationally recognised schooling. The property is a short distance away from excellent shopping at The Avenue at Mearns Cross and Greenlaw Village. There are an abundance of sports and recreational facilities found within the district which include excellent golf courses, parks, tennis clubs and there are a variety of country pursuits found nearby. Local train stations include Whitecraigs Station and Patterton Station.

NM4383 | Sat Nav: 1 Netherton Road, Newton Mearns, G77 6ER

For the full home report visit www.corumproperty.co.uk

* All measurements and distances are approximate Floorplans are for illustration purposes and may not be to scale.



WE'RE **SOLD** ON
YOUR FUTURE



Corum Newton Mearns
134 Ayr Road, Newton Mearns, G77 6EG

Tel: 0141 639 5888

Email: n.mearns@corumproperty.co.uk

www.corumproperty.co.uk