



8 CULZEAN CRESCENT

NEWTON MEARNS

www.corumproperty.co.uk

c o r u m

3 | BEDROOMS
1 | BATHROOM
1 | PUBLIC ROOM

A semi detached villa within lovely gardens with driveway and garage.

- Bright and modern interior in a lovely private setting.
- Near Kirkhill and Mearns Castle schooling.
- Modern designed lounge through to dining room open to fitted kitchen.
- 3 bedrooms and modern bathroom.
- Level gardens with driveway and garage.

Amenities

Newton Mearns is one of the most sought-after suburbs within the south side of Glasgow. The property is superbly placed for a wide range of amenities and indeed nationally recognised schooling. The property is a short distance away from excellent shopping at The Avenue at Mearns Cross and Greenlaw Village. There are an abundance of sports and recreational facilities found within the district which include excellent golf courses, parks, tennis clubs and there are a variety of country pursuits found nearby at Hazeldene. Local train stations include Whitecraigs Station and Patterton Station.

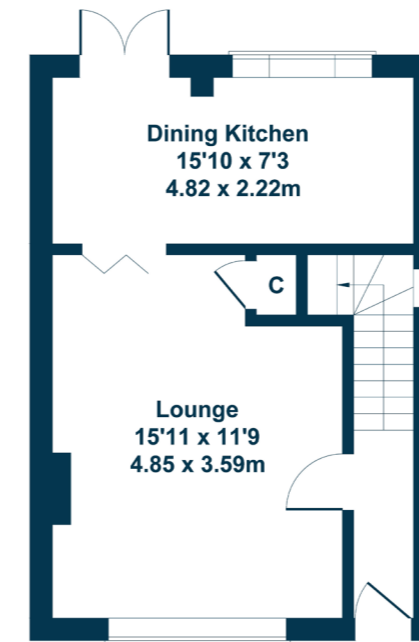

GROUND FLOOR

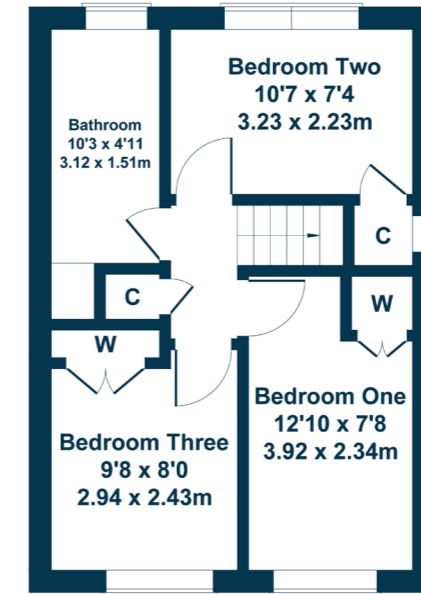

FRIST FLOOR

Sat Nav:
 8 Culzean Crescent, Newton Mearns, G77 5TA

NM4316

*All measurements and distances are approximate. Floorplans are for illustration purposes and may not be to scale.

For the full home report visit
www.corumproperty.co.uk



WE'RE **SOLD** ON
YOUR FUTURE



Corum Newton Mearns
134 Ayr Road, Newton Mearns, G77 6EG

Tel: 0141 639 5888

Email: n.mearns@corumproperty.co.uk

www.corumproperty.co.uk