



# 19 BLACK CART VIEW

## LINWOOD

[www.corumproperty.co.uk](http://www.corumproperty.co.uk)







**3 | BEDROOMS**

**3 | BATHROOMS**

**1 | PUBLIC ROOM**

**A new semi-detached home positioned within the Napier Grove residential development on the rural edges of Linwood within West Renfrewshire. This property has a pleasant setting in private gardens which include a monoblock driveway and a gate leading to the enclosed and turfed rear garden.**

This modern home offers family accommodation of four principal apartments formed over two levels. The specification includes a gas fired central heating system supplemented with solar panels, double glazing, a modern range of fitted kitchen furniture and modern sanitary wear within the bathrooms. The accommodation comprises of a reception hallway with a cloakroom WC and a stair leading to the upper floor. The lounge is a well-proportioned apartment with under stairs storage. The kitchen is open plan to the dining room with a window and French doors to the landscaped rear garden. On the upper floor of the property there is a central hallway with a store cupboard. The main bedroom is positioned to the rear of the property and features a fitted wardrobe and an ensuite shower room. There are two further bedrooms both with wardrobe storage and a bathroom.







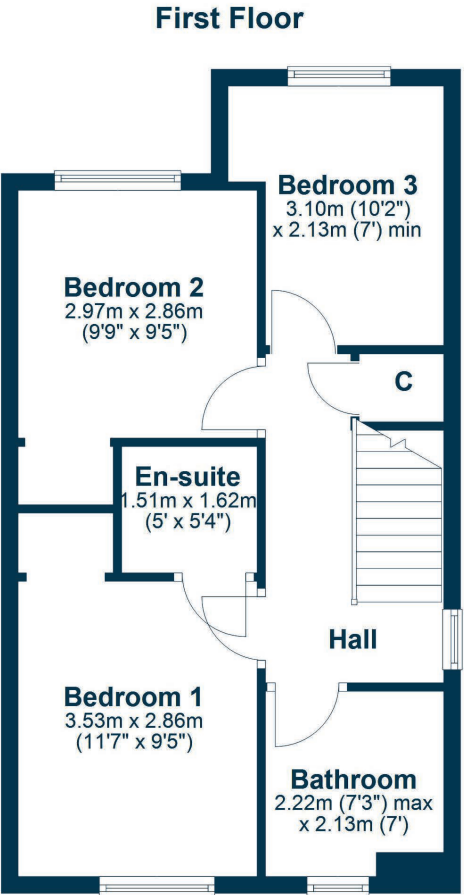
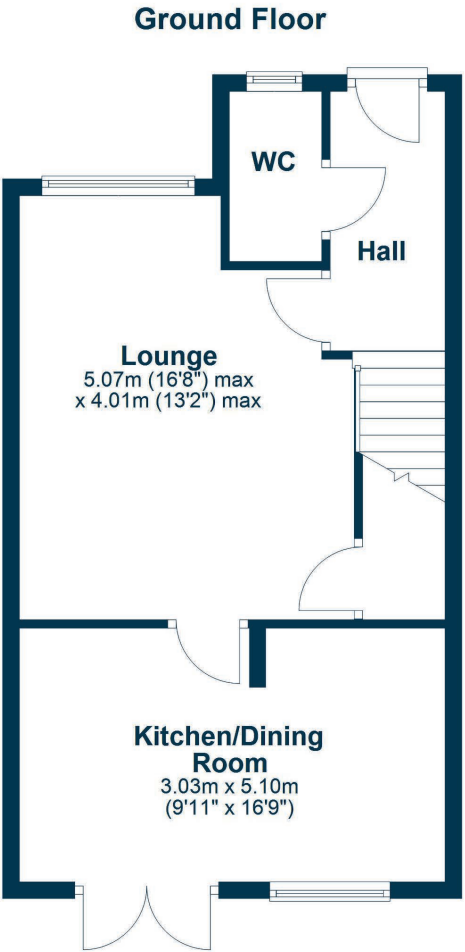

The town of Linwood has excellent road links to the A737 dual carriageway leading to Glasgow International Airport on the M8 motorway serving Glasow City centre. There are a variety of local shops including Tesco and Asda supermarkets and a Showcase cinema. The recently opened On-X sports centre has a swimming pool, gym, sports hall and outdoor sports fields including an athletics track. Local schools include Our Lady of Peace and East Fulton Primary and St Benedicts and Linwood High schools.

**BW2576** | Sat Nav: 19 Black Cart View, Linwood, PA3 3AN

For the full home report visit [www.corumproperty.co.uk](http://www.corumproperty.co.uk)

\* All measurements and distances are approximate Floorplans are for illustration purposes and may not be to scale.





WE'RE **SOLD** ON  
YOUR FUTURE



Corum Bridge of Weir  
2 Windsor Place, Main Street, Bridge Of Weir, PA11 3AF

T: 01505 691 400

E: [bridgeofweir@corumproperty.co.uk](mailto:bridgeofweir@corumproperty.co.uk)

[www.corumproperty.co.uk](http://www.corumproperty.co.uk)